

ARJOHUNTLEIGH

GETINGE GROUP

PASSIVE CLIP SLINGS

INSTRUCTIONS FOR USE



CE

Important information

COMPONENTS OF A SLING

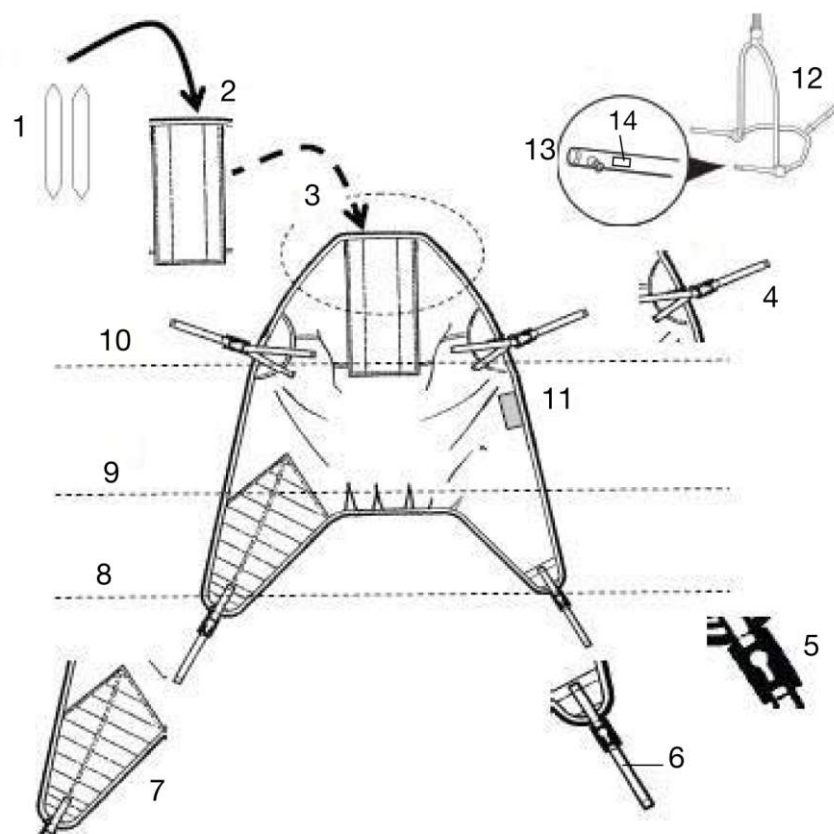
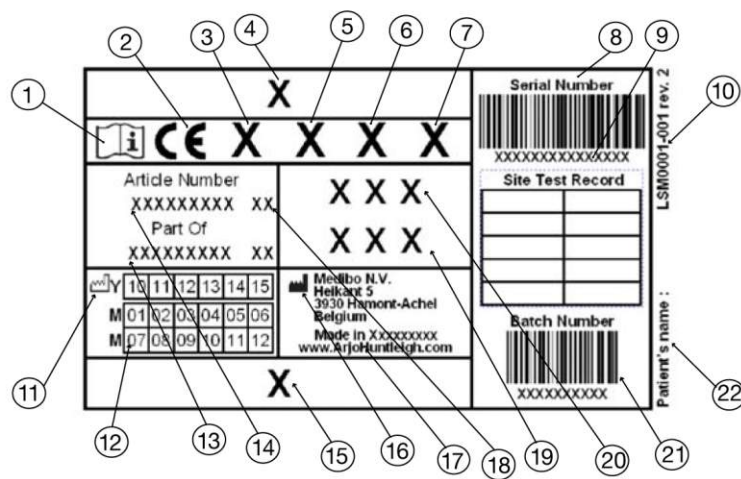

Fig. 1

EXAMPLE OF A SLING LABEL



This label is only used as a reference and is not representative for this sling.

Fig. 2

Important information

Operational life



The operational life of the sling is dependent on the actual use conditions. Therefore, before use, always make sure that the sling straps do not show signs of fraying, tearing or other damage and that there is no damage (i.e cracking, bending, breaking) to the attachment clips. If any such damage is observed, do not use the sling. If you have any doubts about sling safety, as a precaution and to ensure safety, do not use the sling.

Components of a sling (See page 2, fig. 1)

1. Stiffener
2. Stiffener pocket
3. Head piece
4. Shoulder strap
5. Attachment clip
6. Leg strap
7. Leg piece
8. Leg section
9. Body section
10. Head section
11. Sling label
12. Spreader bar (lift component)
13. Attachment lug (lift component)
14. Label for correct clip attachment

Information on label (See page 2, fig. 2)

- | | |
|---|---|
| 1. Read instruction for use | 12. Manufacturing & testing date |
| 2. CE logo | 13. Main article number |
| 3. Wash (symbol) | 14. Article number |
| 4. Company logo | 15. Tailor Made Sling (symbol) |
| 5. Bleach (symbol) | 16. Manufacturer (symbol) |
| 6. Dry (symbol) | 17. Country manufacturer |
| 7. Iron (symbol) | 18. Article size |
| 8. Serial number & corresponding bar code | 19. Equipment to be used or Product description |
| 9. Sling Site Test Record* | 20. Safe Working Load |
| 10. Label article number & issue number | 21. Batch number & corresponding bar code |
| 11. Date of manufacture (symbol) | 22. Space to write patient name |
- * Used in UK for test procedure as described by MHRA
* Can be used to make note for registration and inspection of the sling

Intended use

- ArjoHuntleigh clip slings are intended to be used with ArjoHuntleigh lifters equipped with clip hanger bars only. The right type and size of slings should be used after proper assessment of each resident's size, condition and the type of lifting situation.
- ArjoHuntleigh clip slings must only be used by appropriately trained caregivers with adequate knowledge of the care environment, its common practices and procedures and in accordance with the guidelines in these instructions.

Before use



- **Use the sling according to both the lift and sling Operating and Product Care Instructions.**
- ArjoHuntleigh will not be held responsible for product changes that are not approved by ArjoHuntleigh.
- **Do not use slings with attachment clips on spreader bars with hooks. Do not use slings with attachment loops on spreader bars with attachment lugs.**
- ArjoHuntleigh slings with head support have two pockets at the head section. The pockets must contain plastic stiffeners when using the sling.
- Make sure that the sling is not attached to any object other than the hanger bar attachment lugs of the lift. If the sling is attached improperly, the weight that is put on the sling will increase and surpass the maximum allowed weight. This may cause damage to the attachment clips.
- A clinical assessment should be carried out by a qualified nurse and therapist before lifting residents.
- Special attention should be paid to residents prone to spasms or unexpected movements as they can inadvertently kick off the leg attachment clip
- Residents with implanted medical devices, e.g. artificial stomata or other applications where the implanted medical device can come into contact with the sling, shall not be lifted.
- **The slings should be checked before and after use with each resident and, if necessary, washed according to instructions on the sling. This is especially important when using the same equipment for another resident, to minimize the risk of cross infection.**
- Inspect the sling on a flat surface so that all areas of the sling are visible.

Sling Sizing Guide



Fig. 3



Fig. 4

- The sling size should comply with the resident's body shape and disabilities.
- Ensure that the measurement tape (see Fig. 3) with article number MTA1000, is used the correct way (Teal (seaweed green) colour - XXS at the coccyx (spine)).
- Ideally, the resident should be in a seated position (See Fig. 4).
- Measure from the coccyx to the top of the head. The colour level at the top indicates the required size.
- If the size falls between two sizes, always use the smallest size.
- Resident width and body proportions should also be considered and a professional judgment made.
- This sizing tool is only intended as a guide and is an approximation. Other factors like the resident's physical disabilities, weight distribution and general physique all need to be taken into consideration.
- If you have any further questions on the use of the measurement tape, contact your ArjoHuntleigh Sales Company. Contact data can be found on the last page of these instructions.

Important information

Operating instructions (Guidelines during use)



- When fitting the sling, make sure that the sling label is positioned on the outside of the sling and not against the resident's body.
- Proper body mechanics and sound ergonomic positioning should be maintained by the caregiver during use of the sling.
- To position the resident, use the parts of the lifting device designed for the purpose and avoid touching the resident or the sling. Do not use the sling straps while the resident is suspended in the sling.
- Ensure that the straps connecting the sling to the attachment clips are not twisted when the attachment clips are connected to the spreader bar.
- Verify that the attachment of the clip is not obstructed by the strap.
- Ensure that the strap is not routed around the hanger bar when attaching the clip.
- **Always check that the sling attachment clips are fully in position before and during the commencement of the lifting cycle, and in tension as the resident's weight is gradually taken up. Always check that the clip is mounted on the attachment lugs in its most downward position (See Fig. 5, 6 & 7).**



Fig. 5

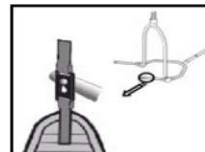

Fig. 6

- If a toilet sling is used, use it with caution. Encourage the resident to hold on tightly to the sling to avoid sliding out. Do not use the toilet sling for lifting and transportation apart from toilet related situations.

Product care instructions (Guidelines after use)



- All sling straps should be checked, and if necessary, washed. Washing and drying temperatures must be according to the label instructions. Wash using normal detergents; do not iron.
- Mechanical pressure is not allowed during the washing and drying procedure, e.g. rolling or pressing, as this can damage parts vital to the safe and comfortable operation of the sling.
- With regard to laundering, slings should not be classified as linen, but as an accessory to a resident transfer lifter. Slings should be cleaned and disinfected only in strict accordance with the manufacturer's instructions.

Washing instructions

Before washing: Remove the plastic stiffeners, if applicable, from the pockets in the sling. Place them back in their pockets before use.

Chemical decontamination: Sodium hypochlorite 150-300ppm in low temperature wash.

Thermal disinfection: Wash at maximum 80°C (176°F) for at least three minutes.

DO NOT USE: IODINE BASED DISINFECTANTS - GAS STERILIZATION - AUTOCLAVE

DO NOT USE MECHANICAL PRESSURE: PRESSING OR ROLLING, DURING THE WASHING OR DRYING PROCEDURES.

Sling storage

Slings should be stored away from direct sunlight where they are not subject to unnecessary strain, stress or pressure, or to excessive heat or humidity. The slings should be kept away from contact with sharp implements, corrosives or other possible causes of damage.

ArjoHuntleigh strongly advise and warn that only ArjoHuntleigh designated parts, which are designed for the purpose, should be used on equipment and other appliances supplied by ArjoHuntleigh, to avoid injuries attributable to the use of inadequate parts. The Company's Conditions of Sale make specific provision confirming no liability in such circumstances. The policy of ArjoHuntleigh is one of continuous development, and we therefore reserve the right to change specifications without notice.

The illustration below is affixed to the lift's spreader bar and means:
Ensure that the clip is mounted on the attachment lug in its most downward position.



Fig. 7

ARJOHUNTLEIGH

CLIP SLING / FLITES

