

## Quickstart Guide: Linkable™ Wireless Receivers and Wireless Switch Latch and Timer (SLAT)

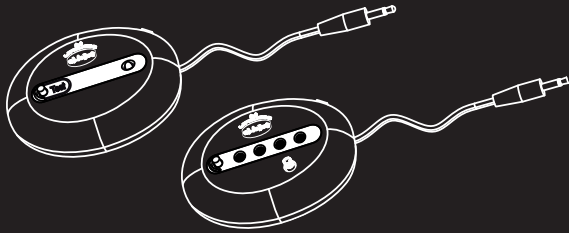

ablenet®

### 1 Insert Batteries and Turn On

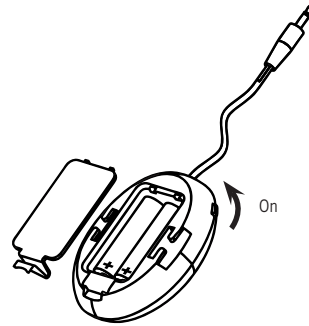

Insert two AA batteries into Receiver as shown on housing.

Slide the power switch to the "On" position. The Receiver's light(s) will activate briefly.

*When batteries are low, the device's light will flash three (3) times.*

### 2 Link Receiver & Transmitter

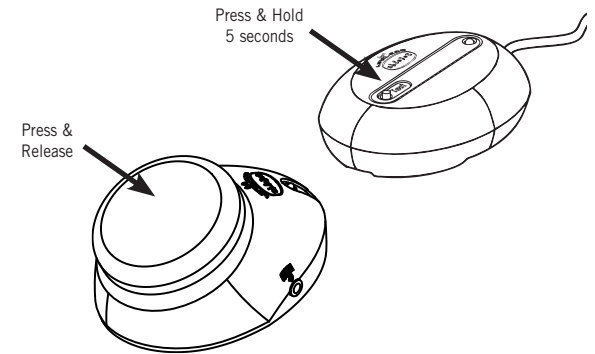

1. With wireless Transmitter and Receiver turned on, press and hold the Receiver's "Test" or "Mode" button until the light turns green (about 5 seconds).
2. Activate any Transmitter. *The Receiver's light will flash red 1 time when a link has been established.*  
*\*Link additional Transmitters by activating them now (optional).*
3. Press and release the Receiver's "Test" or "Mode" button to exit linking mode.

### 3 Connect Receiver & Activate

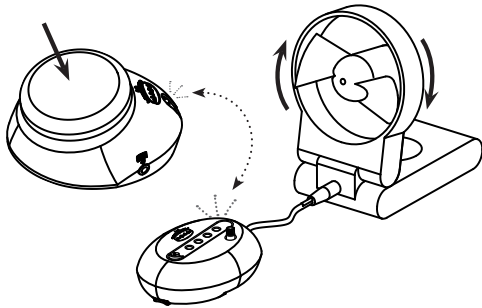

Plug the Receiver into any switch-accessible device or computer switch interface.

Activate the Transmitter.

*The Transmitter and Receiver will light red and the attached device will activate.*

*NOTE: To test the physical connection with a switch-adapted device, press and hold the "Test" or "Mode" button for 2 seconds.*

### Wireless Switch Latch & Timer (SLAT)

Select your Mode of Control by repeatedly pressing the "Mode" button. The Receiver's lights will indicate which mode is activated. For Timed Modes - Adjust the Timer Dial from 1-60 seconds or minutes as desired.\*

#### Modes of Control

- Direct** Traditional switch behavior - device remains ON as long as switch is held.
- Timed Seconds** Runs device from 1 to 60 seconds with each activation.
- Timed Minutes** Runs device from 1 to 60 minutes with each activation.
- Latch** First activation turns device ON; second activation turns it OFF.

*\*PROGRAMMING TIP: Turn the Timer Dial all the way up to 60 and activate the device. As the desired time approaches, turn the Dial back down towards 0, stopping the device at the time desired. The first half-turn of the Timer Dial ranges from 1-10 sec./min. The second half-turn ranges from 11-60 sec./min.*

### Tricks, Tips, and Warranty

Your Receiver has slots on the bottom of the device for mounting with Velcro® straps. For additional mounting options, visit [www.ablenetinc.com](http://www.ablenetinc.com).

You can link up to 8 Transmitters to a Receiver using the linkable method explained in Step 2. When a Receiver's light is green, any activated Transmitter will be linked. One Transmitter can also be linked to multiple Receivers at the same time.

To unlink devices, press and hold the Receiver's "Test" or "Mode" button for more than 10 seconds.

To clean, wipe surfaces with a slightly damp cloth.

#### Warranty Information

AbleNet manufactured products include a two-year limited warranty. This warranty is against defects in materials and manufacturing for two-years from the date of purchase. Warranty in full text, along with return/repair information is available at [www.ablenetinc.com](http://www.ablenetinc.com). For more information on AbleNet products and services, contact:  
AbleNet, Inc.