

1100



SEAT HEIGHT/SLOPE ADJUSTABLE SEAT-REHAB SHOWER/COMMODE CHAIR

- Complete Packages for Easier Ordering Available
- Stainless Steel Frame
- Several Seat Options Available
- Seat Height and Slope Adjustment
- Three Frame Sizes: 18"Wx18"D, 20"Wx18"D, 22"Wx18"D
- 350 lb. (158kg) Weight Capacity

The 1100 is a Rehab Shower/Commode Chair that can be configured with a height/slope adjustable seat when ordered with the 24" rear wheels. This unit has modular components to help alleviate the need for custom designs, and its consequent added costs and delivery time.

The seat height can go low enough for foot propulsion, and the height adjustment can enable safer transfers. These options make the 1100 an easily adaptable rehab shower/commode chair for multi-user facilities and group homes.

FRAMES



P13721
18"Wx18"D
Stainless Steel
Frame



P13722
20"Wx18"D
Stainless Steel
Frame



P13723
22"Wx18"D
Stainless Steel
Frame

WHEELS/REAR CASTERS



P13854
5" Dual Locking
Casters
(pair)



P13862
24" Wheels
(pair)



P13864
24" Pneumatic
Street Tread
Wheels
(pair)



P13865
24" Flat Free Street
Tread Wheels
(pair)



P13857
24" PVC Handrims
(replaces standard
handrims, pair)

AXLES



P13708
Bolted Axles with
Tipping Levers
(pair)



P13707
Quick Release
Axles with Tipping
Levers
(pair)



P60532
Wheel Locks
(pair)



P13724
Wheel Locks with
Offset Handle
(pair)



P60841-2
5" Casters
(pair)



P60800-2
5" Dual Locking
Casters
(pair)

WHEEL LOCKS

FRONT CASTERS

SEATS

*Seat works in all 4 positions



P60993*
18"Wx18"D
Comfortuff 1.5" waterfall
foam
Front/Rear Open Seat
A-5"xB-8" opening



P60974
18"Wx18"D
Comfortuff sloped foam
Front Open Seat
A-4"xB-6.5" opening



P60850*
18"Wx18"D
Ensolite® 1" waterfall foam
Front/Rear Open Seat
A5"xB-8" opening



P60913*
18"Wx18"D
Ensolite® 2" waterfall foam
Front/Rear Open Seat
A5.25"xB-8" opening



P61086
18"Wx18"D
Ensolite® 2" foam
Solid Seat



P61058
18"Wx18"D
Ensolite® 2" waterfall foam
Front Open Contoured Seat
A-5.5"xB-8.25" opening



P61038
20"Wx18"D
Comfortuff
1.5" waterfall foam
Front Open Seat
A-5"xB-8" opening



P60903
20"Wx18"D
Ensolite® 1" foam
Front/Rear Open Seat
A-4.5"xB-7.75" opening



P60905
22"Wx18"D
Ensolite® 1" foam
Front/Rear Open Seat
A-4.5"xB-7.75" opening

Front/Rear Open Seat
Opening Measurements

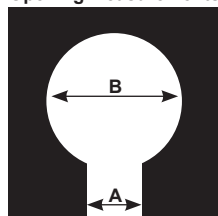

ARMRESTS



P13715
Left Hand Armrest
with Pad



P13716
Right Hand Armrest
with Pad



P13717
Left Hand with
Arm Trough



P13718
Right Hand with
Arm Trough



P13615
Left Hand
Height-Adjustable
Armrest



P13616
Right Hand
Height-Adjustable
Armrest

1100 OPTIONS

LEG RESTS



PL13725
Left Leg Rest



PR13725
Right Leg Rest



P13571
Left Elevating
Leg Rest



P13572
Right Elevating
Leg Rest



PL11099
Left Foot Plate



PR11099
Right Foot Plate



PL11100
Left Foot Plate with
Heel Loop

FOOT PLATES



PR11100
Right Foot Plate
with Heel Loop



P13891
Left Oversized
Aluminum
Foot Plate



P13892
Right Oversized
Aluminum
Foot Plate



PL11101
Left Padded
Foot Plate



PR11101
Right Padded
Foot Plate



P13690
18"W Sling Back
with Stroller
Handles



P13692
18"W Sling Back
with Stroller
Handles
(adjustable depth)

BACKS



P13691
18"W Solid Back



P13693
18"W Solid Back
(adjustable depth)



P13710
20"W Sling Back
with Stroller
Handles



P13713
20"W Solid Back



P13712
22"W Sling Back
with Stroller
Handles



P13714
22"W Solid Back

BELTS



PW60909
Waist Belt
(for 18"W frame only, 54"
circumference with
12" overlap)



PW60884
Waist Belt
(for 20"W and 22"W
frame only, 66" and 68"
circumference with
12" overlap)



PT60884
Trunk Belt
(64", 66" and 68"
circumference with
12" overlap)



P60879
Calf Strap



P11093
Bodypoint®
Trunk Belt



P11102
Bodypoint®
Trunk Belt (pair)



P11116
Bodypoint® Trunk
Belt & Waist Belt

POSITIONING AIDS



P11112
Bodypoint® XL
Trunk Belt



P11113
Bodypoint® Belt
w/Quick Release
Knobs



P61081
Bodypoint®
Calf Strap



P11114
Bodypoint®
Knee Belt



PL13574
Left Hand
Swing-Away
Adjustable Lateral



PR13574
Right Hand
Swing-Away
Adjustable Lateral



P61006
Abductor/Deflector
Large

PANS



P13834
18"Wx18"D
Pan/Hanger



P13836
20"Wx18"D
Pan/Hanger



P13838
22"Wx18"D
Pan/Hanger



1100 with Four 5"
Locking Casters

SPECIFICATIONS

		18" Frame	20" Frame	22" Frame
Weight Capacity		350 lbs. (158kg)	350 lbs. (158kg)	350 lbs. (158kg)
Seat Width		18" (45cm)	20" (50cm)	22" (55cm)
Width between Arm Rests	Armrest with Pad	20.25" (51cm)	22.25" (56cm)	24.25" (61cm)
	Armrest with Arm Troughs	18.25" (46cm)	20.25" (51cm)	22.25" (56cm)
	Height Adjustable	18.75" (47cm)	20.75" (52cm)	22.75" (57cm)
Seat Depth		18" (45cm)	18" (45cm)	18" (45cm)
Adjustable Seat Height Range From Floor to Top of Seat (transfer height)	24" wheels	23.75"-20.75" (60-52cm)	with 23"-18" (58-45cm)-Rear Slope	
	5" casters	23.75"-20.75" (60-52cm)		
Leg Rest Range	Gooseneck	15.75"-19.75" (40-50cm)	with Padded Footplate	
	Elevating - Up	16.5"-23.5" (41-59cm)	14.5"-18.5" (36-46cm)	
	Elevating - Down	16.5"-23.5" (41-59cm)	15.25"-22.25" (38-56cm)	
Usable Seat Depth w/Solid Back		18" (45cm)	18" (45cm)	18" (45cm)
Arm Height from Top of Seat	Armrest with Pad		7.75" (19cm)	
	Armrest with Arm Troughs		8" (20cm)	
	Height Adjustable		4"-12" (10-30cm)	
Back Height From Top of Seat			18.5" (46cm)	
Gap between Top of Seat and Bottom of Back			10.5" (26cm)	
Seat to Back Angle (or Range) (Recline)			13°	
Adjustable Depth Back Range			2.5" (6cm)	
Under Seat Height Clearance	with 24" Wheels	15"-18" (38-45cm)	min. tilt/13.25"-16.25" (33-41cm) max. tilt	
	with 5" Casters	15"-18" (38-45cm)		
Under Seat Width Clearance	with 24" Wheels	14.5" (25cm)	16.5" (41cm)	18.5" (46cm)
	with 5" Casters	15.75" (40cm)	17.75" (45cm)	19.75" (50cm)
Overall Width	with 24" Wheels	25.25" (64cm)	27.25" (69cm)	29.25" (74cm)
	with 5" Casters and Armrest w/Pad	24.25" (64cm)	26.25" (66cm)	28.25" (71cm)
	with 5" Casters and Height Adjustable Armrests	22" (55cm)	24" (60cm)	26" (66cm)
	with 5" Casters and Armrest with Arm Troughs	28.25" (71cm)	30.25" (76cm)	32.25" (81cm)
Overall Length	Min. with 24" Wheels	44" (111cm)	44" (111cm)	44" (111cm)
	Min. with 5" Casters	41.5" (105cm)	41.5" (105cm)	41.5" (105cm)
Back of Unit to Start of Commode Opening	with 24" Wheels		17.25" (43cm)	
	with 5" Casters		14.75" (37.5cm)	
Turning Diameter Min. w/ 5" rear casters		48" (121cm)	49" (124cm)	50" (127cm)
Seat Used to Generate Specifications		#60993 18"Wx18"Dx2.5"H		