

285



TILT- REHAB SHOWER/COMMODE CHAIR

- Complete Packages for Easier Ordering Available
- Stainless Steel Frame
- Several Seat Options Available
- Tilt Adjustment
- 350 lb. (158kg) Weight Capacity
- Four Frame Sizes:
16" Wx18"D, 18" Wx18"D,
20" Wx18"D and 22" Wx18"D
- Seven Seat Sizes:
16" Wx18"D, 18" Wx18"D,
18" Wx20"D, 20" Wx18"D,
20" Wx20"D, 22" Wx18"D
and 22" Wx20"D

The 285 is a gravity assist tilt-in-space shower/commode chair. Available in multiple frame widths from 16"-22" and the option of 4 casters or 24" rear wheels make this is a versatile chair for the home or rehab environment.

Multiple features combine to provide support, comfort, and pressure relief, along with the other benefits of tilt-in-space technology.

FRAMES



P13635
16"Wx18"D
Stainless Steel
Frame



P13636
18"Wx18"D
Stainless Steel
Frame



P13637
20"Wx18"D
Stainless Steel
Frame



P13638
22"Wx18"D
Stainless Steel
Frame



P60800-2
5" Dual Locking
Casters
(pair)



P13862
24" Wheels
(pair)



P13864
24" Pneumatic
Street Tread
Wheels
(pair)

AXLES

WHEEL LOCKS

FRONT CASTERS



P13865
24" Flat Free Street
Tread Wheels
(pair)



P13857
24" PVC Handrims
(replaces standard
handrims, pair)



P13688
Bolted Axles with
Tipping Levers
(pair)



P60532
Wheel Locks
(pair)



P13135
Wheel Locks with
Extended Handle
(pair)



P60841-2
5" Casters
(pair)



P60800-2
5" Dual Locking
Casters
(pair)

SEATS



P61124
16"Wx18"D
Ensolite® 1" foam
Front/Rear Open Seat
A-4.75"xB-7.75" opening



P60993
18"Wx18"D
Comfortuff 1.5" waterfall foam
Front/Rear Open Seat
A-5"xB-8" opening



P60974
18"Wx18"D
Comfortuff sloped foam
Front Open Seat
A-4"xB-6.5" opening



P60802
18"Wx18"D
Ensolite® 1.25" foam
Front Open Ring Seat
A-4.5"xB-7.75" opening



P61086
18"Wx18"D
Ensolite® 2" foam
Solid Seat



P61121
18"Wx20"D
Ensolite® 1" foam
Front Open Seat
A-4.5"xB-7.5" opening



P61038
20"Wx18"D
Comfortuff
1.5" waterfall foam
Front Open Seat
A-5"xB-8" opening



P60903
20"Wx18"D
Ensolite® 1" foam
Front/Rear Open Seat
A-4.5"xB-7.75" opening



PP61122
20"Wx18"D
Ensolite® 1" foam
Solid Seat



P60886
20"Wx20"D
Ensolite® 1.5" foam
Race Track Oval Seat
A-7.75"xB-12.75" opening



P61123
20"Wx20"D
Ensolite® 1" waterfall foam
Front/Rear Open Seat
A-4.5"xB-7.75" opening



P60905
22"Wx18"D
Ensolite® 1" foam
Front/Rear Open Seat
A-4.5"xB-7.75" opening



P60887
22"Wx20"D
Ensolite® 1.5" foam
Race Track Oval Seat
A-7.75"xB-12.75" opening



P61126
22"Wx20"D
Ensolite® 1" waterfall foam
Front/Rear Open Seat
A-4.5"xB-7.75" opening

ARMRESTS



P13611
Left Hand Armrest
with Pad



P13612
Right Hand Armrest
with Pad



P13613
Left Hand Armrest
with Arm Trough



P13614
Right Hand Armrest
with Arm Trough



P13615
Left Hand
Height-Adjustable
Armrest



P13616
Right Hand
Height-Adjustable
Armrest

LEG RESTS

FOOT PLATES



PL13581
Left Gooseneck
Leg Rest



PR13581
Right Gooseneck
Leg Rest



P13582
Left Elevating
Leg Rest



P13583
Right Elevating
Leg Rest



PL11099
Left Foot Plate



PR11099
Right Foot Plate



PL11100
Left Foot Plate with
Heel Loop

285 OPTIONS

FOOT PLATES



PR11100
Right Foot Plate
with Heel Loop



P13891
Left Oversized
Aluminum
Foot Plate



P13892
Right Oversized
Aluminum
Foot Plate



PL11101
Left Padded
Foot Plate



PR11101
Right Padded
Foot Plate



P61139
16"W Adjustable
Sling Back



P11106
16"W Solid Back
Full Length w/
Center Pad



P11110
16"W Solid Back



P60877
18"W Adjustable
Sling Back



P11107
18"W Solid Back



P60878
20"W Adjustable
Sling Back



P11108
20"W Solid Back



P61140
22"W Adjustable
Sling Back



P11109
22"W Solid Back

BELTS



PW60884
Waist Belt
(62", 64", 66", or 68"
circumference with
12" overlap)



PT60910
Trunk Belt
(for 16"W and 18"W
frames only, 48"
circumference with 12"
overlap)



PT61180
Trunk Belt
(for 20"W and 22"W
frames only, 58"
circumference with 12"
overlap)



P60879
Calf Strap



P11093
Bodypoint®
Trunk Belt



P11102
Bodypoint®
Trunk Belt (pair)



P11116
Bodypoint® Trunk
Belt & Waist Belt

POSITIONING AIDS



P11112
Bodypoint® XL
Trunk Belt



P11113
Bodypoint® Belt
w/Quick Release
Knobs



P61081
Bodypoint®
Calf Strap



P11114
Bodypoint®
Knee Belt



PL13574
Left Hand
Swing-Away
Adjustable Lateral



PR13574
Right Hand
Swing-Away
Adjustable Lateral



PL13618
Left Hand
Arm-Mounted
Hip Guide

PANS



PR13618
Right Hand
Arm-Mounted
Hip Guide



P61006
Abductor/Deflector
Small



P13831
Pan/Hanger for
Ring and
Contoured Seats



P13832
Pan/Hanger for
Front/Rear, & Race
Track Oval Seats



P11105
Head Support
Small Foam
(only available for
P11106)



P13621
Head Support
Large

HEAD SUPPORTS

Front Open Seat
Opening Measurements

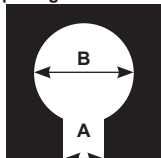

Race Track Oval
Opening Measurements

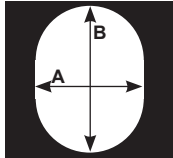



285 in Tilt



PKG207 Package #5 - 18"W x 18"D

SPECIFICATIONS

	16" Frame (158kg)	18" Frame	20" Frame	22" Frame
Weight Capacity	350 lbs.	350 lbs.	350 lbs.	350 lbs.
Seat Width	16" (40cm)	18" (45cm)	20" (50cm)	22" (55cm)
Width between Arm Rests	18.75" (47cm)	20.75" (52cm)	22.75" (57cm)	24.75" (62cm)
	Armrest with Pad	16.75" (42cm)	18.75" (47cm)	20.75" (52cm)
	Armrest with Arm Troughs	16.25" (41cm)	18.25" (46cm)	20.25" (51cm)
	Height Adjustable Armrests	18" (45cm)	18" (45cm)	18" (45cm)
Seat Depth	18" (45cm)	18" (45cm)	18" (45cm)	18" (45cm)
Seat Height Range From Floor to Top of Seat (transfer height)	Front to Back - 24" Wheels - 24.25"-22" (61-55cm) 5"rear casters - 24.25"-22.75" (61-57cm) <u>with Padded Footplate</u>			
Leg Rest Range				
	Gooseneck	16.5"-20.5" (41-52cm)	15.25"-19.25" (38-48cm)	
	Elevating - Up	19"-26" (48-66cm)	17.75"-24.75" (45-62cm)	
	Elevating - Down	18.5"-25.5" (46-64cm)	17.25"-24.25" (43-61cm)	
Usable Seat Depth w/Solid Back	16" (40cm)			
Arm Height from Top of Seat	8" (20cm)			
	Armrest with Pad	8.25" (20cm)		
	Armrest with Arm Troughs	7.5"-15" (19-38cm)		
	Height Adjustable Armrests	22" (55cm)		
Back Height From Top of Seat	4" (10cm)			
Gap between top of seat and bottom of back	4" (10cm)			
Maximum Back Slack	14°			
Seat to Back Angle (or Range) (Recline)	5°-29°			
Tilt Range	20.5"-28.5" (52-72cm)			
Head Support Height Range - top of Seat to bottom of Cervical Support	19" (48cm)			
Under Seat Height Clearance	16.75" (42cm)	18.75" (47cm)	20.75" (52cm)	22.75" (57cm)
Under Seat Width Clearance	27" (68cm)	29" (73cm)	31" (78cm)	33" (83cm)
Overall Width with 24" Wheels	23.5" (59cm)	25.5" (64cm)	27.5" (69cm)	29.5" (74cm)
with 5" Casters and Armrest w/Pad	27" (68cm)	29" (73cm)	31" (78cm)	33" (83cm)
with 5" Casters and Armrest with Arm Troughs	27" (68cm)	29" (73cm)	31" (78cm)	33" (83cm)
with 5" Casters and Height Adjustable Armrests	23" (58cm)	25" (63cm)	27" (68cm)	29" (73cm)
Overall Length Min. with 24" Wheels	47.75" (121cm)			
Min. with 5" Casters	47.25" (120cm)			
Max Tilted w/Headrest & Legrest ext.	60" (152cm)			
Back of Unit to Start of Commode Opening	19" (48cm)			
Turning Diameter Min. w/ 5" rear casters	50" (127cm)			
Seat Used to Generate Specifications	#60905 22"Wx18"Dx2"H			