

# POSAline® Shoulder Positioner Assembly Instructions

The POSAline® Shoulder Positioner is designed for rigid support to help position the clients shoulders and upper body. We are committed to providing the very best service and will where deemed necessary by you, provide additional training in the assembly of the shoulder positioner. The device is designed for positioning and this should be undertaken by suitably qualified and competent persons including rehabilitation engineers and occupational therapists.

**Tools required:** 1/8" (3mm) and 5/16" (4mm) Allen Keys

**Step 1:** Remove screw 'E' from post 'D' and loosen knob 'M' so that post 'D' can be removed from mounting block 'A'. Attach mounting block 'A' to the desired location on the backrest: Locate and punch out two mounting holes in the backrest where the mounting block is to be attached, Insert and tighten two 1/4" flathead screws 'C' through mounting block 'A', through the backrest and into weld nut B. Reinsert post 'D' into mounting block 'A' and reinsert and tighten screw 'E' into end of post 'D'.\*

### Step 2: Vertical Adjustment

Loosen knob 'M' to slide post 'D' up or down to achieve desired height. Retighten knob 'M'. Set and tighten clamp 'L' so that it rests flush with the top of mounting block 'A'. With clamp 'L' set the whole assembly can be easily swung out of the way and repositioned exactly by loosening knob 'M' and lifting and twisting the assembly out of the way. Reposition by moving the assembly until clamp 'L' is back in place and tighten clamp 'M'.

### Step 3: Horizontal Adjustment

Loosen screw 'G' and/or 'H'. Slide the pad assembly 'J' along rod 'K' or slide rod 'K' through the clamp at screw 'G' until pad is positioned as desired. Retighten screws 'G' and 'H'.\*

### Step 4: Additional Adjustments

Knob 'M' (with a ratcheting adjustment feature) and screws 'F', 'G', 'H' and 'I' allow many axes of adjustment. The pad can be placed virtually anywhere and at almost any angle within the range

of posts 'D' and 'K'. With the screws loose the pad 'J' can be positioned exactly as desired. The screws can then be retightened to maintain that position.\*

### Note:

This device is not intended to take the place of or considered to be a substitute for seat belts or other restraints required for transportation.

\*All screws to be tightened to 20 in-lb (2.3 N).

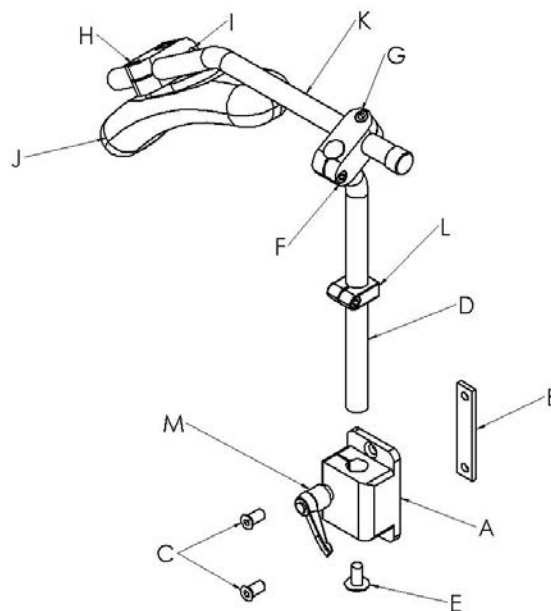

Authorized Representative:  
Medimark Europe BP2332  
38033 Grenoble Cedex 2  
France

This product is manufactured  
to comply with the 'Medical  
Device Directive'