



**PUSH-BUTTON BUCKLE & COVERS**

Light-weight, low-profile, superior strength & durability.  
Requires 5# (22 N) of force to release.

**PLASTIC SIDE-RELEASE**

Lightweight, secure snap action.

**REHAB LATCH**

Light-weight, strong, low-profile,  
easy to operate with limited hand function.  
Requires < 1# (4.5 N) of force to release when unloaded.  
Requires 12# (53 N) of force to release under 300# of tension.

**SWIVEL BUCKLE**

Light-weight, strong, and low-profile.  
Swivel action allows closing up to 45° off centerline.  
90° of rotation while buckled.

**X-SMALL METAL PUSH-BUTTON**

Strong, secure, child-sized buckle.  
Requires 4.5# (20 N) of force to release.

-S32  
-S38

FITS 1"  
WEBBING

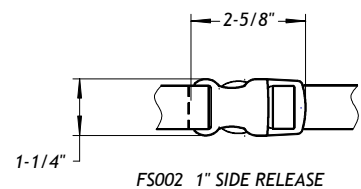

FS002 1" SIDE RELEASE

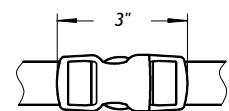

FS012 1" DUAL SIDE RELEASE  
(USED ON DUAL-PULL BELTS ONLY)

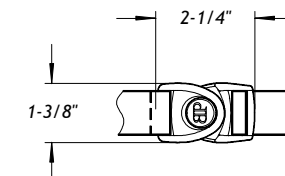

FS035 1" SWIVEL BUCKLE  
Requires 10# (45 N) of force to release.

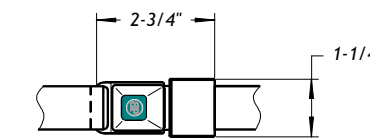

FS029-BP BUCKLE WITH ADJUSTABLE TONGUE

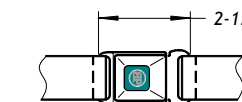

FS029-BP BUCKLE WITH FIXED TONGUE  
(USED ON REAR-PULL BELTS ONLY)

-M36  
-M40  
-M46

FITS 1-1/2"  
WEBBING

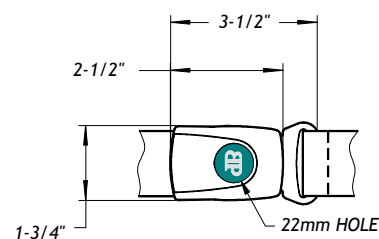

FS018 1-1/2" PUSH-BUTTON BUCKLE

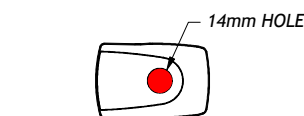

FS018D-1 REDUCED ACCESS COVER

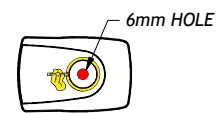

FS018C-1 SECURITY COVER

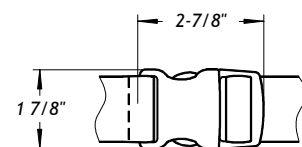

FS003 1-1/2" SIDE RELEASE

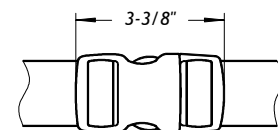

FS013 1-1/2" DUAL SIDE RELEASE  
(USED ON DUAL-PULL BELTS ONLY)

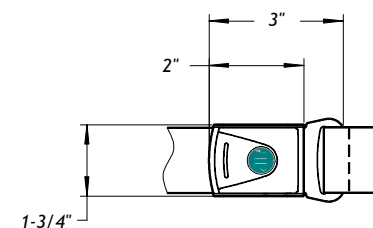

FS016 1-1/2" REHAB LATCH BUCKLE

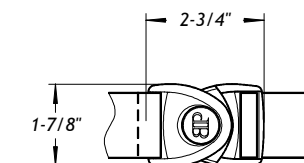

FS036 1-1/2" SWIVEL BUCKLE  
Requires 12# (53 N) of force to release.

-L62  
-L82  
-L92

FITS 2"  
WEBBING

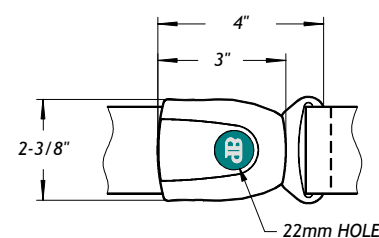

FS019 2" PUSH-BUTTON BUCKLE

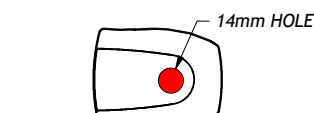

FS019D-1 REDUCED ACCESS COVER

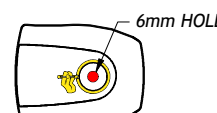

FS019C-1 SECURITY COVER

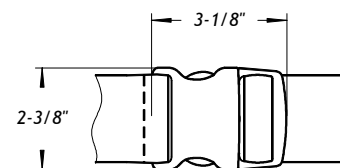

FS004 2" SIDE RELEASE

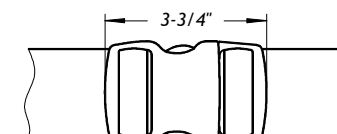

FS014 2" DUAL SIDE RELEASE  
(USED ON DUAL-PULL BELTS ONLY)

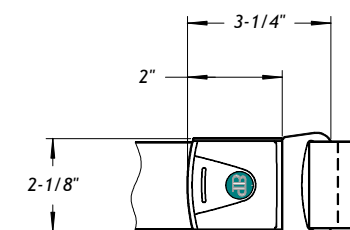

FS017 2" REHAB LATCH BUCKLE

note

DIMENSIONS ARE FOR REFERENCE ONLY.

description

**HIP BELT BUCKLES TECHNICAL SPECS**

drawing no.  
**D11-0920-34**

date originated  
9/20/2011

drawn by  
D. HAGAN

rev.  
**D**