

ACTA-EMBRACE® LTS Back Support Order Form



SEATING + POSITIONING

HCPCS CODING: E2620/E2621 - POSITIONING BACK,
PLANAR WITH LATERAL SUPPORTS

Since U.S. Medicare coding is subject to change, the provider should always confirm the HCPCS code and coverage criteria as part of the client assessment process.



Shown with Compass® 4 Quick Release 2 Point Hardware.
Cover appearance may vary with hardware selection.

Company Name/ACCT #: _____

P.O. Number: _____

Requested By: _____

Phone: _____ Fax: _____

Email: _____

Ship To: _____

Client Reference: _____

DO NOT SEND PROTECTED HEALTH INFORMATION. IT IS NOT NEEDED TO MAKE THE PRODUCT YOU ARE REQUESTING.

1 SIZE SELECTION Required

BASE MSRP BY SIZE*

LENGTH*	22"	\$832.00	\$910.00					
	20"							
	18"	\$758.00	\$850.00					
	16"							
	14"							
	12"							
10"								
	10"	12"	14"	16"	18"	20"	22"	24"
	FRAME WIDTH							

Sizes available are subject to hardware being used.

AELTS-BS

Please fill in the above with dimensions from the size charts to the right.
Example Part: **AELTS-BS14W16L**

Hardware will be selected in Section 2.

10W10L	12W10L	14W10L	16W10L
--------	--------	--------	--------

Please note these sizes are not available with 4 POINT hardware if using a head support.

*Length (L) refers to the actual size dimension of the support from bottom to top edge.

Sizes available with 2 POINT Mounting Hardware

LENGTH*	22"			16W22L	18W22L	20W22L	22W22L	
	20"		14W20L	16W20L	18W20L	20W20L	22W20L	
	18"		12W18L	14W18L	16W18L	18W18L	20W18L	22W18L
	16"		12W16L	14W16L	16W16L	18W16L	20W16L	22W16L
	14"	10W14L	12W14L	14W14L	16W14L	18W14L	20W14L	
	12"	10W12L	12W12L	14W12L	16W12L	18W12L		
10"	10W10L	12W10L	14W10L	16W10L				
	10"	12"	14"	16"	18"	20"	22"	24"
	FRAME WIDTH							

Sizes available with 4 POINT Mounting Hardware

LENGTH*	22"			16W22L	18W22L	20W22L	22W22L	24W22L
	20"		14W20L	16W20L	18W20L	20W20L	22W20L	24W20L
	18"		12W18L	14W18L	16W18L	18W18L	20W18L	22W18L
	16"		12W16L	14W16L	16W16L	18W16L	20W16L	22W16L
	14"	10W14L	12W14L	14W14L	16W14L	18W14L	20W14L	
	12"	10W12L	12W12L	14W12L	16W12L	18W12L		
10"	10W10L	12W10L	14W10L	16W10L				
	10"	12"	14"	16"	18"	20"	22"	24"
	FRAME WIDTH							

Sizes available with POWER Mounting Hardware

LENGTH*	22"			16W22L	18W22L	20W22L	22W22L	24W22L
	20"		14W20L	16W20L	18W20L	20W20L	22W20L	24W20L
	18"		12W18L	14W18L	16W18L	18W18L	20W18L	22W18L
	16"		12W16L	14W16L	16W16L	18W16L	20W16L	22W16L
	14"		12W14L	14W14L	16W14L	18W14L	20W14L	
	12"		12W12L	14W12L	16W12L	18W12L		
10"								
	10"	12"	14"	16"	18"	20"	22"	24"
	FRAME WIDTH							

2 COVER & HARDWARE SELECTION

Required

2.1 COVER SELECTION

MSRP \$0.00

Both fabrics are made without latex. Fabric selection is for the support surface only. Other fabrics used in cover construction remain the same.



COMFORT-TEK® is a smooth, easily cleaned surface. The fluid protection aids in infection control.



STRETCH-AIR® has comfortable stretch, air transmission and heat dissipation. It is not fluid resistant.

COMFORT-TEK Cover
(COMFORT-TEK)

STRETCH-AIR Cover
(STRETCH-AIR)

2.2 HARDWARE STYLE

COMPASS 4 QUICK RELEASE

Price included in back support purchase

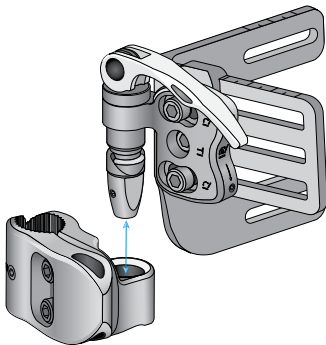

COMPASS 4 FIXED

Price included in back support purchase

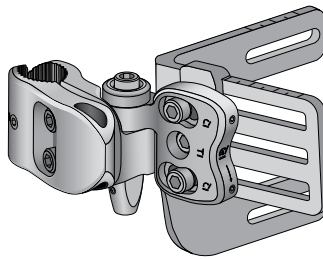

FIXED fully adjustable hardware requires tools for back support removal

COMPASS POWER MOUNT

MSRP add \$40.00

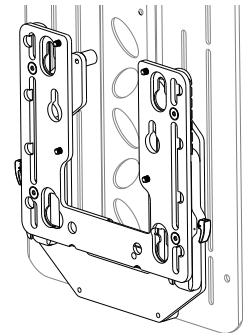

POWER MOUNT hardware has 8" of height adjustment in 1/2" increments without using tools.

QUICK RELEASE 2 POINT
(Q-COMPASS)

QUICK RELEASE 4 POINT
(Q-COMPASS4)

FIXED 2 POINT
(NQ-COMPASS)

FIXED 4 POINT
(NQ-COMPASS4)

QUANTUM w/ TRU BALANCE 3
(PMB-QUANTUM)

PERMOBIL w/ CORPUS 3G
(PMB-PERMOBIL)

QUICKIE w/ 3.7 POWER
(PMB-QUICKIE)

AVID REHAB w/ POWER T & R
(PMB-AVID)

ROVI w/ MOTION CONCEPTS*
(PMB-ROVI)

4 POINT hardware is required on all 24"W back supports using Compass 4 hardware.

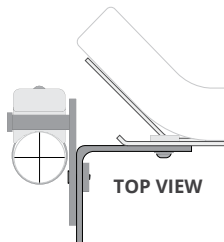

*Using Power Mount Hardware on ROVI requires mounting to the RECESSED PLANAR INTERFACE PLATE available when ordering the Motion Concepts Seating System. Drilling is required for mounting.

3 LATERAL TRUNK SUPPORT SELECTION

3.1 Required (3.2 Optional)

3.1 LATERAL TRUNK SUPPORT

Price included in back support purchase

Length (L) refers to the actual size dimension of the support from top to bottom edge.
Depth (D) refers to the actual size dimension of the support from anterior to posterior edge.

- LTS back supports come with moldable supports and fixed mounting hardware.
- Hardware is width and depth adjustable. Height adjustable on back support shell.
- Adjustments require tools.

MOLDABLE SUPPORT **FIXED HARDWARE**

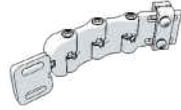
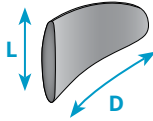

Size	Cover Style	
3" L x 4" D	COMFORT-TEK (LAT-3L4D-COMFORT-TEK)	
	STRETCH-AIR (LAT-3L4D-STRETCH-AIR)	
4" L x 5" D	COMFORT-TEK (LAT-4L5D-COMFORT-TEK)	
	STRETCH-AIR (LAT-4L5D-STRETCH-AIR)	
4" L x 6.5" D	COMFORT-TEK (LAT-4L6D-COMFORT-TEK)	
	STRETCH-AIR (LAT-4L6D-STRETCH-AIR)	
5" L x 6.5" D	COMFORT-TEK (LAT-5L6D-COMFORT-TEK)	
	STRETCH-AIR (LAT-5L6D-STRETCH-AIR)	

COMFORT-TEK
FOR FLUID PROTECTION & AN EASILY CLEANED SURFACE.

STRETCH-AIR
FOR COMFORT & HEAT DISSIPATION.

3.2 ADDITIONAL LATERAL TRUNK SUPPORT HARDWARE

SWING-AWAY HARDWARE

HCPCS Code: E1028
MSRP: \$298.00/ea.

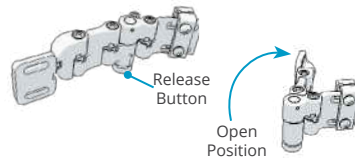

LEFT	RIGHT
BL-LTS-GT2SAS-LH	BL-LTS-GT2SAS-RH

Hardware is width and depth adjustable. Height adjustable on back support shell. Adjustments require tools.

**"EXTRA" parts may not fit depending on back support, pad, and hardware size and style combinations.

EXTRA HARDWARE LINKS



LEFT	ADD'L LEFT
BL-LTS-GT2LINK	BL-LTS-GT2LINK
RIGHT	ADD'L RIGHT
BL-LTS-GT2LINK	BL-LTS-GT2LINK

HARDWARE COVER

MSRP \$26.00 ea.



LEFT	RIGHT
BL-LTS-HCOVER	BL-LTS-HCOVER

WINTER/SUMMER HDWR

MSRP \$154.00 ea.



LEFT	RIGHT
BL-LTS-HWSAE-LH	BL-LTS-HWSAE-RH

4 BACK SUPPORT ADD-ON SELECTIONS

Optional

4.1 PRIVACY FLAP

MSRP \$37.00

This flap connects with hook & loop attachment between the seat and back for added privacy.

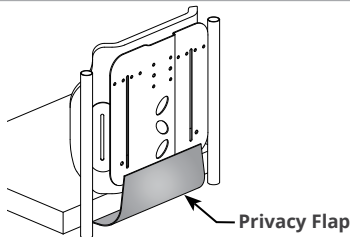

PRIVACY FLAP (PV-FLAP)

5 BODILINK® HEAD SUPPORT HARDWARE & PADS

- You may make one selection per column.
- Choose pad firmness and size in 5.1.
- Choose a cover material in 5.2.

5.1 PREMIUM PAD SIZE

HCPCS CODING: E0955 MSRP \$237.00

Length (L) refers to the actual size dimension of the support from bottom to top edge.

		Pad Firmness	
L	6W x 3L	Soft	BL-HSP1-6W3L
		Extra Soft	BL-HSP2-6W3L
L	8W x 4L	Soft	BL-HSP1-8W4L
		Extra Soft	BL-HSP2-8W4L
L	10W x 5L <i>with adjustable wings</i>	Soft	BL-HSP1-10W5L
		Extra Soft	BL-HSP2-10W5L
L	12W x 5L <i>with adjustable wings</i>	Soft	BL-HSP1-12W5L
		Extra Soft	BL-HSP2-12W5L
L	14W x 5L <i>with adjustable wings</i>	Soft	BL-HSP1-14W5L
		Extra Soft	BL-HSP2-14W5L
L	18W x 5L <i>with adjustable wings</i>	Soft	BL-HSP1-18W5L
		Extra Soft	BL-HSP2-18W5L



Premium Head Support Pads angles can be formed by adjusting the plates in the pad.

5.2 PREMIUM PAD COVER MATERIAL

GlideWear™ technology

FOR SKIN PROTECTION & SHEAR REDUCTION. NOT FLUID RESISTANT.

COMFORT-TEK®

FOR FLUID PROTECTION & AN EASILY CLEANED SURFACE.

STRETCH-AIR®

FOR COMFORT.

	GlideWear™ (GLIDEWEAR) (add \$26.00)
	COMFORT-TEK (COMFORT-TEK)
	STRETCH-AIR (STRETCH-AIR)

5.3 PT HARDWARE

- You may make one selection per column.
- Choose PT hardware type in 5.3 A or B.
- If choosing A, select a stem size immediately after.

RANGE OF MOTION

PT MODEL	TOTAL # OF LINKS	TOTAL LINK LENGTH	MAX ANTERIOR REACH	MAX POSTERIOR REACH	MAX LATERAL REACH
MID 6	2	6"	5.5"	1"	N/A
LAT 6	3	6"	5.5"	1"	6"
MID 8	2	8"	7.5"	1"	N/A
LAT 8	3	8"	7.5"	1"	8"
MAX 8	4	8"	7.5"	3"	8"

A. PT HARDWARE, REMOVABLE

HCPCS E1028

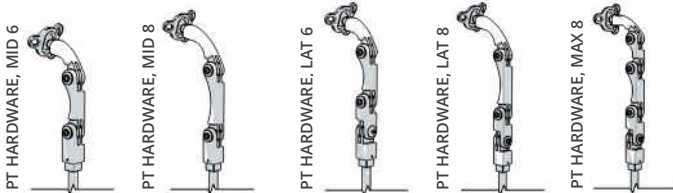

SHAPE	MSRP	PART NUMBER
MID 6	\$223.00	(BL-HS-PT1RMMID6)
LAT 6	\$260.00	(BL-HS-PT1RMLAT6)
MID 8	\$223.00	(BL-HS-PT1RMMID8)
LAT 8	\$260.00	(BL-HS-PT1RMLAT8)
MAX 8*	\$327.00	(BL-HS-PT1RMMAX8)

*Provides the greatest amount of articulation and range of motion.

PT HARDWARE, REMOVABLE, STEM LENGTH OPTION

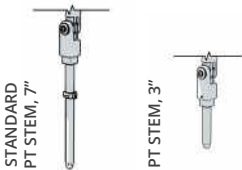

STEM LENGTH	MSRP	PART NUMBER
STANDARD 7" STEM	\$0.00	(HS-STEM-7)
**3" STEM	\$0.00	(HS-STEM-3)

**3" Stem is recommended for use with power mounting where there may be special constraints with power chair functions.

B. PT HARDWARE, FLIP-DOWN

HCPCS E1028

Flip-Down Hardware has 7" Stem

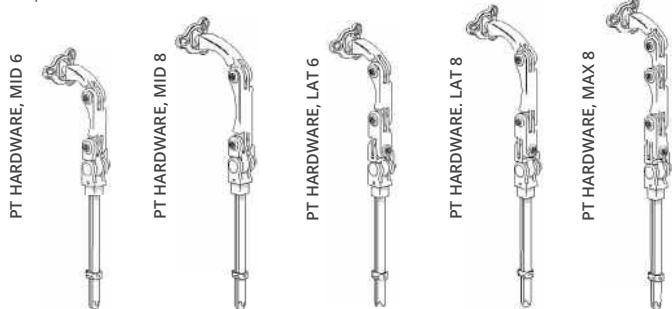

SHAPE	MSRP	PART NUMBER
MID 6	\$273.00	(BL-HS-PT1FDMID6)
LAT 6	\$310.00	(BL-HS-PT1FDLAT6)
MID 8	\$273.00	(BL-HS-PT1FDMID8)
LAT 8	\$310.00	(BL-HS-PT1FDLAT8)
MAX 8*	\$357.00	(BL-HS-PT1FDMAX8)

*Provides the greatest amount of articulation and range of motion.

5.4 HEAD SUPPORT MOUNTING OPTION



MOUNTING BLOCK-POSTERIOR A

MOUNTING BLOCK OR BRACKET	MSRP	PART NUMBER
POSTERIOR A MOUNTING BLOCK	\$0.00	(HS-MB-POSTA)

5.5 EXTRA HARDWARE



LINK LENGTH	MSRP	EXTRA PART
*EXTRA 2" LINK	\$57.00	(BL-HS-PT1LINK2)



*EXTRA 3" LINK	\$57.00	(BL-HS-PT1LINK3)
----------------	---------	------------------



*EXTRA 4" LINK	\$57.00	(BL-HS-PT1LINK4)
----------------	---------	------------------



TOOL-LESS WING LOCK	MSRP	EXTRA PART	EXTRA PART	EXTRA PART	EXTRA PART
*1 LOCK	\$21.00/each	(BL-HS-52WINGA1)	(BL-HS-52WINGA1)	(BL-HS-52WINGA1)	(BL-HS-52WINGA1)



ADDITIONAL	MSRP	EXTRA PART
1/4" SPACER PLATE	\$37.00/each	(BL-HS-SPCRA)

*FOR PT HARDWARE ONLY

6 STRAP GUIDE EXTENSION

Optional

6.1 STRAP GUIDE EXTENSION BRACKET

MSRP \$61.00/set

SIZE
Extra Small (up to 1 1/2" w webbing) (CHG2-EB1)
Small (up to 2 1/4" w webbing) (CHG2-EB2)

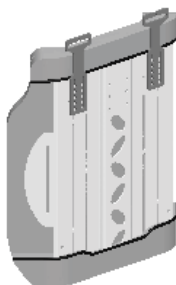

The following are trademarks and registered trademarks of Permobil Seating and Positioning: ACTA-EMBRACE®, BodiLink®, COMFORT-TEK®, Compass®, and STRETCH-AIR®. GlideWear™ is a trademark of MIPS.