

ACTA-BACK® Back Support Order Form

HCPCS CODING: E2613/E2614 - POSITIONING BACK

Since U.S. Medicare coding is subject to change, the provider should always confirm the HCPCS code and coverage criteria as part of the client assessment process.



Shown with Compass® 4 Quick Release 2 Point Hardware.
Cover appearance may vary with hardware selection.

This back support is also available in CUSTOM

permobil

SEATING + POSITIONING

Company Name/ACCT #: _____

P.O. Number: _____

Requested By: _____

Phone: _____ Fax: _____

Email: _____

Ship To: _____

Client Reference: _____

DO NOT SEND PROTECTED HEALTH INFORMATION. IT IS NOT NEEDED TO MAKE THE PRODUCT YOU ARE REQUESTING.

1 SIZE SELECTION

Required

BASE MSRP BY SIZE

LENGTH*	22"	\$594.00	\$673.00				
	20"						
LENGTH*	18"	\$523.00	\$614.00				
	16"						
	14"						
	12"						
10"							
	12"	14"	16"	18"	20"	22"	24"
	FRAME WIDTH						

Sizes available are subject to hardware being used.

AB-BS _____

Please fill in the above with dimensions from the size charts to the right.

Example Part: **AB-BS14W16L**

Hardware will be selected in Section 2.

12W10L	14W10L	16W10L	18W10L
--------	--------	--------	--------

Please note these sizes are not available with lateral trunk supports or a head support.

*Length (L) refers to the actual size dimension of the support from bottom to top edge.

Sizes available with 2 POINT Mounting Hardware

LENGTH*	22"		16W22L	18W22L	20W22L	22W22L	
	20"		14W20L	16W20L	18W20L	20W20L	22W20L
LENGTH*	18"	12W18L	14W18L	16W18L	18W18L	20W18L	22W18L
	16"	12W16L	14W16L	16W16L	18W16L	20W16L	22W16L
LENGTH*	14"	12W14L	14W14L	16W14L	18W14L	20W14L	
	12"	12W12L	14W12L	16W12L	18W12L		
10"	12W10L	14W10L	16W10L	18W10L			
	12"	14"	16"	18"	20"	22"	24"
	FRAME WIDTH						

Sizes available with 4 POINT Mounting Hardware

LENGTH*	22"		16W22L	18W22L	20W22L	22W22L	24W22L
	20"		14W20L	16W20L	18W20L	20W20L	22W20L
LENGTH*	18"	12W18L	14W18L	16W18L	18W18L	20W18L	22W18L
	16"	12W16L	14W16L	16W16L	18W16L	20W16L	22W16L
LENGTH*	14"	12W14L	14W14L	16W14L	18W14L	20W14L	
	12"	12W12L	14W12L	16W12L	18W12L		
10"	12W10L	14W10L	16W10L	18W10L			
	12"	14"	16"	18"	20"	22"	24"
	FRAME WIDTH						

Sizes available with POWER Mounting Hardware

LENGTH*	22"		16W22L	18W22L	20W22L	22W22L	24W22L
	20"		14W20L	16W20L	18W20L	20W20L	22W20L
LENGTH*	18"		14W18L	16W18L	18W18L	20W18L	22W18L
	16"		14W16L	16W16L	18W16L	20W16L	22W16L
LENGTH*	14"	12W14L	14W14L	16W14L	18W14L	20W14L	
	12"	12W12L	14W12L	16W12L	18W12L		
10"							
	12"	14"	16"	18"	20"	22"	24"
	FRAME WIDTH						

2 COVER & HARDWARE SELECTION

Required

2.1 COVER SELECTION

MSRP \$0.00

Both fabrics are made without latex. Fabric selection is for the support surface only. Other fabrics used in cover construction remain the same.



COMFORT-TEK® is a smooth, easily cleaned surface. The fluid protection aids in infection control.



STRETCH-AIR® has comfortable stretch, air transmission and heat dissipation. It is not fluid resistant.

COMFORT-TEK Cover
(COMFORT-TEK)

STRETCH-AIR Cover
(STRETCH-AIR)

2.2 HARDWARE STYLE

COMPASS 4 QUICK RELEASE

Price included in back support purchase

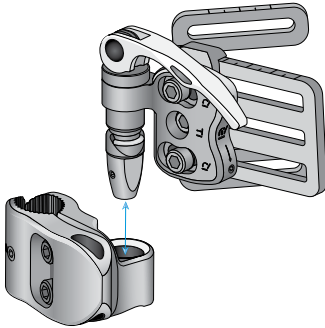

QUICK RELEASE 2 POINT
(Q-COMPASS)

QUICK RELEASE 4 POINT
(Q-COMPASS4)

4 POINT hardware is required on all 24"W back supports using Compass 4 hardware.

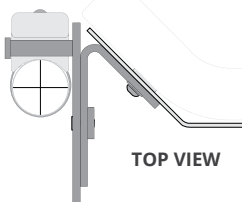

COMPASS 4 FIXED

Price included in back support purchase

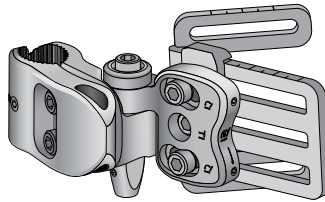

FIXED fully adjustable hardware requires tools for back support removal

FIXED 2 POINT
(NQ-COMPASS)

FIXED 4 POINT
(NQ-COMPASS4)

COMPASS POWER MOUNT

MSRP add \$40.00

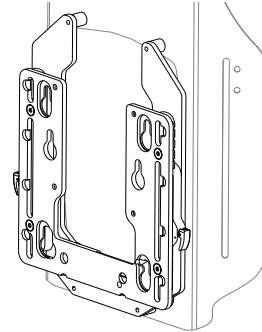

POWER MOUNT hardware has 8" of height adjustment in ½" increments without using tools.

QUANTUM w/ TRU BALANCE 3
(PMB-QUANTUM)

PERMOBIL w/ CORPUS 3G
(PMB-PERMOBIL)

QUICKIE w/ 3.7 POWER
(PMB-QUICKIE)

AVID REHAB w/ POWER T & R
(PMB-AVID)

ROVI w/ MOTION CONCEPTS*
(PMB-ROVI)

*Using Power Mount Hardware on ROVI requires mounting to the RECESSED PLANAR INTERFACE PLATE available when ordering the Motion Concepts Seating System. Drilling is required for mounting.

3 BACK SUPPORT ADD-ON SELECTIONS

Optional

3.1 COLOR

MSRP \$26.00

Accent colors are applied via colored piping. Placement of the piping may vary by back support size and mounting hardware. If no colors are selected, our standard silver reflective piping is used at no additional cost.



Color Location

RED (RED)
PURPLE (PURPLE)
PINK (PINK)
BLUE (BLUE)
GREEN (GREEN)
ORANGE (ORANGE)
REMOVE (REMOVE)

3.2 EMBROIDERY

MSRP \$26.00

A. THREAD COLOR OPTIONS

RED (EMB-RED)	BLUE (EMB-BLUE)
PURPLE (EMB-PURPLE)	GREEN (EMB-GREEN)
PINK (EMB-PINK)	SILVER (EMB-SILVER)

B. FONT OPTIONS

Helvetica (EMB-Helvetica)	Twilight (EMB-Twilight)
Garamond (EMB-Garamond)	Script (EMB-Script)

C. WORD ONE
(Input is case sensitive. Please enter exactly as you want the words to look. Example: Marcus or marcus or MARCUS)

WORD TWO (optional)
(Input is case sensitive. Please enter exactly as you want the words to look. Example: Marcus or marcus or MARCUS)

*ADDITIONAL LEAD TIMES MAY APPLY

3.3 PRIVACY FLAP

MSRP \$37.00

This flap connects with hook & loop attachment between the seat and back for added privacy.

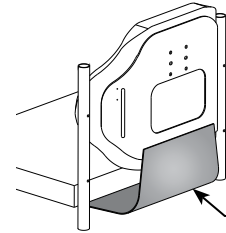

Privacy Flap

PRIVACY FLAP (PV-FLAP)

4 BODILINK® LATERAL TRUNK SUPPORT & HARDWARE

4.1 GT2 MOUNTING HARDWARE

Both Fixed and Swing-Away hardware styles are adjustable.

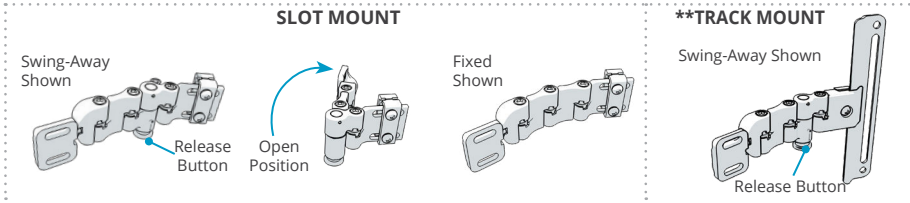

- You may make one selection per column in section 4.1.
- **TRACK MOUNT is only available when using Compass 4 Hardware. If using Compass® Power Mount hardware, select slot mounting lateral hardware.
- *"Extra" Track Mount Hardware does not come with an extra track

SLOT MOUNTING		MSRP	LEFT	*EXTRA LEFT	RIGHT	*EXTRA RIGHT
OR	SWING-AWAY HCPCS Code: E1028	\$298.00/ea.	BL-LTS-GT2SAS-LH	BL-LTS-GT2SAS-LH	BL-LTS-GT2SAS-RH	BL-LTS-GT2SAS-RH
	FIXED	\$178.00/ea.	BL-LTS-GT2FXS-LH	BL-LTS-GT2FXS-LH	BL-LTS-GT2FXS-RH	BL-LTS-GT2FXS-RH
**TRACK MOUNTING		MSRP	LEFT	*EXTRA LEFT	RIGHT	*EXTRA RIGHT
OR	SWING-AWAY HCPCS Code: E1028	\$298.00/ea.	BL-LTS-GT2SAT-LH	BL-LTS-GT2SATX-LH	BL-LTS-GT2SAT-RH	BL-LTS-GT2SATX-RH
	FIXED	\$178.00/ea.	BL-LTS-GT2FXT-LH	BL-LTS-GT2FXTX-LH	BL-LTS-GT2FXT-RH	BL-LTS-GT2FXTX-RH

ACTA-BACK-ORDER REV120320

4.2

PREMIUM PAD SIZE & SHAPE

HCPCS Code: E0956 MSRP \$88.00/ea.

- You may make one selection per column in section 4.2.
- Follow each column down to sections 4.3 and 4.4 and select a style and cover for each pad selected in section 4.2.

*Length (L) refers to the dimension of the support from top to bottom edge. Depth (D) refers to the dimension of the support from anterior to posterior edge.

	SHAPE	SIZE	LEFT	*EXTRA LEFT	RIGHT	*EXTRA RIGHT
SUPPORTIVE		3"L x 4"D	BL-LTSP2S-3L4D-LH	BL-LTSP2S-3L4D-LH	BL-LTSP2S-3L4D-RH	BL-LTSP2S-3L4D-RH
		3"L x 5.5"D	BL-LTSP2S-3L5D-LH	BL-LTSP2S-3L5D-LH	BL-LTSP2S-3L5D-RH	BL-LTSP2S-3L5D-RH
		4"L x 5"D	BL-LTSP2S-4L5D-LH	BL-LTSP2S-4L5D-LH	BL-LTSP2S-4L5D-RH	BL-LTSP2S-4L5D-RH
		4"L x 6.5"D	BL-LTSP2S-4L6D-LH	BL-LTSP2S-4L6D-LH	BL-LTSP2S-4L6D-RH	BL-LTSP2S-4L6D-RH
		5"L x 6.5"D	BL-LTSP2S-5L6D-LH	BL-LTSP2S-5L6D-LH	BL-LTSP2S-5L6D-RH	BL-LTSP2S-5L6D-RH
		6"L x 6.5"D	BL-LTSP2S-6L6D-LH	BL-LTSP2S-6L6D-LH	BL-LTSP2S-6L6D-RH	BL-LTSP2S-6L6D-RH
OR	ACTIVE		BL-LTSP2A-3L4D-LH	BL-LTSP2A-3L4D-LH	BL-LTSP2A-3L4D-RH	BL-LTSP2A-3L4D-RH
			BL-LTSP2A-3L5D-LH	BL-LTSP2A-3L5D-LH	BL-LTSP2A-3L5D-RH	BL-LTSP2A-3L5D-RH
			BL-LTSP2A-4L5D-LH	BL-LTSP2A-4L5D-LH	BL-LTSP2A-4L5D-RH	BL-LTSP2A-4L5D-RH
			BL-LTSP2A-4L6D-LH	BL-LTSP2A-4L6D-LH	BL-LTSP2A-4L6D-RH	BL-LTSP2A-4L6D-RH
			BL-LTSP2A-5L6D-LH	BL-LTSP2A-5L6D-LH	BL-LTSP2A-5L6D-RH	BL-LTSP2A-5L6D-RH
			BL-LTSP2A-6L6D-LH	BL-LTSP2A-6L6D-LH	BL-LTSP2A-6L6D-RH	BL-LTSP2A-6L6D-RH

*"EXTRA" parts may not fit depending on back support, pad, and hardware size and style combinations. Please contact customer support with questions.

4.3

PREMIUM PAD STYLE

MSRP \$0.00/ea.



	STYLE OPTIONS	LEFT	*EXTRA LEFT	RIGHT	*EXTRA RIGHT
OR	MOLDABLE	LTS-P2-MOLD	LTS-P2-MOLD	LTS-P2-MOLD	LTS-P2-MOLD
	RIGID	LTS-P2-RIGID	LTS-P2-RIGID	LTS-P2-RIGID	LTS-P2-RIGID

4.4

PREMIUM PAD COVER

COMFORT-TEK
FOR FLUID PROTECTION & AN EASILY CLEANED SURFACE.

STRETCH-AIR
FOR COMFORT & HEAT DISSIPATION.

FOR SKIN PROTECTION & SHEAR REDUCTION.
NOT FLUID RESISTANT.

COVER with FOAM
FOR SOFT FEEL AND ADDITIONAL CUSHIONING SUPPORT.

COVER OPTIONS	MSRP	LEFT	*EXTRA LEFT	RIGHT	*EXTRA RIGHT
NO COVER	\$0.00/ea.	LTS-P2-NO-CV	LTS-P2-NO-CV	LTS-P2-NO-CV	LTS-P2-NO-CV
COMFORT-TEK	\$0.00/ea.	LTS-P2-COMFORT	LTS-P2-COMFORT	LTS-P2-COMFORT	LTS-P2-COMFORT
STRETCH-AIR	\$0.00/ea.	LTS-P2-STRETCH	LTS-P2-STRETCH	LTS-P2-STRETCH	LTS-P2-STRETCH
GLIDEWEAR™	\$13.00/ea.	LTS-P2-GLIDE	LTS-P2-GLIDE	LTS-P2-GLIDE	LTS-P2-GLIDE
COMFORT-TEK with FOAM	\$13.00/ea.	LTS-P2-COMFORT-FM	LTS-P2-COMFORT-FM	LTS-P2-COMFORT-FM	LTS-P2-COMFORT-FM
STRETCH-AIR with FOAM	\$13.00/ea.	LTS-P2-STRETCH-FM	LTS-P2-STRETCH-FM	LTS-P2-STRETCH-FM	LTS-P2-STRETCH-FM
GLIDEWEAR with FOAM	\$26.00/ea.	LTS-P2-GLIDE-FM	LTS-P2-GLIDE-FM	LTS-P2-GLIDE-FM	LTS-P2-GLIDE-FM

ACTA-BACK-ORDER REV120320

4.5

BASIC PAD SIZE & SHAPE

HCPCS Code: E0956 MSRP \$82.00/ea.

• You may make one selection per column in section 4.5.
 • Follow each column down to sections 4.6 and 4.7 and select a style and cover for each pad selected in section 4.5.

*Length (L) refers to the actual size dimension of the support from top to bottom edge. Depth (D) refers to the actual size dimension from anterior to posterior edge.

	SHAPE	SIZE	LEFT	*EXTRA LEFT	RIGHT	*EXTRA RIGHT
			BL-LTSP1S-3L4D-LH	BL-LTSP1S-3L4D-LH	BL-LTSP1S-3L4D-RH	BL-LTSP1S-3L4D-RH
SUPPORTIVE		3"L x 4"D	BL-LTSP1S-3L5D-LH	BL-LTSP1S-3L5D-LH	BL-LTSP1S-3L5D-RH	BL-LTSP1S-3L5D-RH
		3"L x 5"D	BL-LTSP1S-4L5D-LH	BL-LTSP1S-4L5D-LH	BL-LTSP1S-4L5D-RH	BL-LTSP1S-4L5D-RH
		4"L x 5"D	BL-LTSP1S-4L6D-LH	BL-LTSP1S-4L6D-LH	BL-LTSP1S-4L6D-RH	BL-LTSP1S-4L6D-RH
		4"L x 6"D	BL-LTSP1S-5L7D-LH	BL-LTSP1S-5L7D-LH	BL-LTSP1S-5L7D-RH	BL-LTSP1S-5L7D-RH
		5"L x 7"D	BL-LTSP1S-6L6D-LH	BL-LTSP1S-6L6D-LH	BL-LTSP1S-6L6D-RH	BL-LTSP1S-6L6D-RH
6"L x 6"D						
OR						
ACTIVE		3"L x 4"D	BL-LTSP1A-3L4D-LH	BL-LTSP1A-3L4D-LH	BL-LTSP1A-3L4D-RH	BL-LTSP1A-3L4D-RH
		3"L x 5"D	BL-LTSP1A-3L5D-LH	BL-LTSP1A-3L5D-LH	BL-LTSP1A-3L5D-RH	BL-LTSP1A-3L5D-RH
		4"L x 5"D	BL-LTSP1A-4L5D-LH	BL-LTSP1A-4L5D-LH	BL-LTSP1A-4L5D-RH	BL-LTSP1A-4L5D-RH
		4"L x 6"D	BL-LTSP1A-4L6D-LH	BL-LTSP1A-4L6D-LH	BL-LTSP1A-4L6D-RH	BL-LTSP1A-4L6D-RH
		5"L x 7"D	BL-LTSP1A-5L7D-LH	BL-LTSP1A-5L7D-LH	BL-LTSP1A-5L7D-RH	BL-LTSP1A-5L7D-RH
6"L x 6"D	BL-LTSP1A-6L6D-LH	BL-LTSP1A-6L6D-LH	BL-LTSP1A-6L6D-RH	BL-LTSP1A-6L6D-RH		

Contact Customer Support for custom sizes. 800.736.0925.

*"EXTRA" parts may not fit depending on back support, pad, and hardware size and style combinations. Please contact customer support with questions.

4.6

BASIC PAD STYLE

MSRP \$0.00/ea.

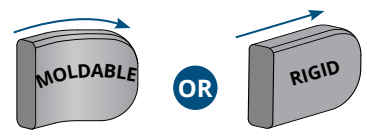

STYLE OPTIONS	LEFT	*EXTRA LEFT	RIGHT	*EXTRA RIGHT
MOLDABLE	LTS-P1-MOLD	LTS-P1-MOLD	LTS-P1-MOLD	LTS-P1-MOLD
RIGID	LTS-P1-RIGID	LTS-P1-RIGID	LTS-P1-RIGID	LTS-P1-RIGID

4.7

BASIC PAD COVER

MSRP \$0.00/ea.



COVER OPTIONS	LEFT	*EXTRA LEFT	RIGHT	*EXTRA RIGHT
COMFORT-TEK	LTS-P1-COMFORT	LTS-P1-COMFORT	LTS-P1-COMFORT	LTS-P1-COMFORT
STRETCH-AIR	LTS-P1-STRETCH	LTS-P1-STRETCH	LTS-P1-STRETCH	LTS-P1-STRETCH

4.8

GT2 ADDITIONAL OPTIONS

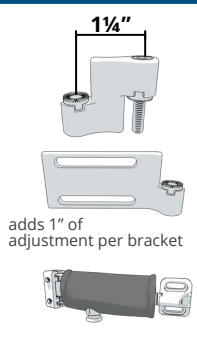

EXTRA HARDWARE LINKS	LEFT	ADD'L LEFT	RIGHT	ADD'L RIGHT
MSRP \$37.00/link	BL-LTS-GT2LINK	BL-LTS-GT2LINK	BL-LTS-GT2LINK	BL-LTS-GT2LINK
LONG MOUNTING BRACKET	LEFT	*EXTRA LEFT	RIGHT	*EXTRA RIGHT
For Slot Mount MSRP \$37.00/ea	BL-LTS-GT2LSLOT-LH	BL-LTS-GT2LSLOT-LH	BL-LTS-GT2LSLOT-RH	BL-LTS-GT2LSLOT-RH
HARDWARE COVER	LEFT	*EXTRA LEFT	RIGHT	*EXTRA RIGHT
MSRP \$26.00/ea	BL-LTS-HCOVER	BL-LTS-HCOVER	BL-LTS-HCOVER	BL-LTS-HCOVER

5 BODILINK HEAD SUPPORT HARDWARE & PADS

- You may make one selection per column.
- Choose pad firmness and size in 5.1.
- Choose a cover material in 5.2.

5.1 PREMIUM PAD SIZE

HCPCS CODING: E0955 MSRP \$237.00

Length (L) refers to the actual size dimension of the support from bottom to top edge.

		Pad Firmness	
L	6W x 3L	Soft	BL-HSP1-6W3L
		Extra Soft	BL-HSP2-6W3L
L	8W x 4L	Soft	BL-HSP1-8W4L
		Extra Soft	BL-HSP2-8W4L
L	10W x 5L <i>with adjustable wings</i>	Soft	BL-HSP1-10W5L
		Extra Soft	BL-HSP2-10W5L
L	12W x 5L <i>with adjustable wings</i>	Soft	BL-HSP1-12W5L
		Extra Soft	BL-HSP2-12W5L
L	14W x 5L <i>with adjustable wings</i>	Soft	BL-HSP1-14W5L
		Extra Soft	BL-HSP2-14W5L
L	18W x 5L <i>with adjustable wings</i>	Soft	BL-HSP1-18W5L
		Extra Soft	BL-HSP2-18W5L



Premium Head Support Pads angles can be formed by adjusting the plates in the pad.

5.2 PREMIUM PAD COVER MATERIAL

	FOR SKIN PROTECTION & SHEAR REDUCTION. NOT FLUID RESISTANT.
	FOR FLUID PROTECTION & AN EASILY CLEANED SURFACE.
	FOR COMFORT.

	GlideWear (GLIDEWEAR) (add \$26.00)
	Comfort-Tek (COMFORT-TEK)
	Stretch-Air (STRETCH-AIR)

5.3 PT HARDWARE

- You may make one selection per column.
- Choose PT hardware type in 5.3 A or B.
- If choosing A, select a stem size immediately after.

RANGE OF MOTION

PT MODEL	TOTAL # OF LINKS	TOTAL LINK LENGTH	MAX ANTERIOR REACH	MAX POSTERIOR REACH	MAX LATERAL REACH
MID 6	2	6"	5.5"	1"	N/A
LAT 6	3	6"	5.5"	1"	6"
MID 8	2	8"	7.5"	1"	N/A
LAT 8	3	8"	7.5"	1"	8"
MAX 8	4	8"	7.5"	3"	8"

A. PT HARDWARE, REMOVABLE

HCPCS E1028

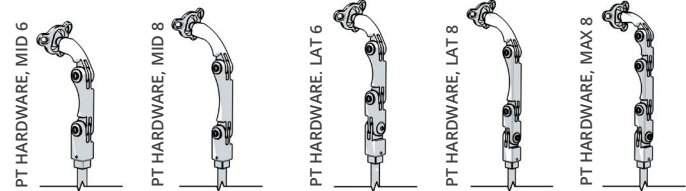

SHAPE	MSRP	PART NUMBER
MID 6	\$223.00	(BL-HS-PT1RMMID6)
LAT 6	\$260.00	(BL-HS-PT1RMLAT6)
MID 8	\$223.00	(BL-HS-PT1RMMID8)
LAT 8	\$260.00	(BL-HS-PT1RMLAT8)
MAX 8*	\$327.00	(BL-HS-PT1RMMAX8)

*Provides the greatest amount of articulation and range of motion.

PT HARDWARE, REMOVABLE, STEM LENGTH OPTION

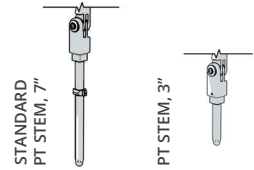

STEM LENGTH	MSRP	PART NUMBER
STANDARD 7" STEM	\$0.00	(HS-STEM-7)
**3" STEM	\$0.00	(HS-STEM-3)

**3" Stem is recommended for use with power mounting where there may be special constraints with power chair functions.

B. PT HARDWARE, FLIP-DOWN

HCPCS E1028

Flip-Down Hardware has 7" Stem

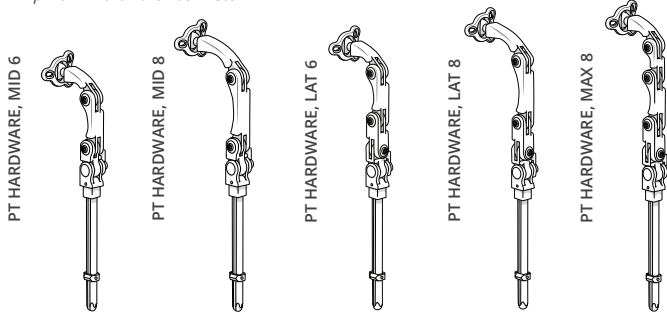

SHAPE	MSRP	PART NUMBER	
MID 6	\$273.00	(BL-HS-PT1FDMID6)	
LAT 6	\$310.00	(BL-HS-PT1FDLAT6)	
MID 8	\$273.00	(BL-HS-PT1FDMID8)	
LAT 8	\$310.00	(BL-HS-PT1FDLAT8)	
MAX 8*	\$357.00	(BL-HS-PT1FDMAX8)	

*Provides the greatest amount of articulation and range of motion.

5.4 HEAD SUPPORT MOUNTING OPTION



MOUNTING BLOCK-POSTERIOR A

MOUNTING BLOCK OR BRACKET	MSRP	PART NUMBER	
POSTERIOR A MOUNTING BLOCK	\$0.00	(HS-MB-POSTA)	

5.5 EXTRA HARDWARE



LINK LENGTH	MSRP	EXTRA PART	
*EXTRA 2" LINK	\$57.00	(BL-HS-PT1LINK2)	



*EXTRA 3" LINK	\$57.00	(BL-HS-PT1LINK3)	
----------------	---------	------------------	--



*EXTRA 4" LINK	\$57.00	(BL-HS-PT1LINK4)	
----------------	---------	------------------	--

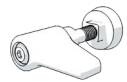

TOOL-LESS WING LOCK	MSRP	EXTRA PART		EXTRA PART	EXTRA PART	EXTRA PART
*1 LOCK	\$21.00/each	(BL-HS-52WINGA1)	(BL-HS-52WINGA1)	(BL-HS-52WINGA1)	(BL-HS-52WINGA1)	



ADDITIONAL	MSRP	EXTRA PART	
1/4" SPACER PLATE	\$37.00/each	(BL-HS-SPCRA)	

*FOR PT HARDWARE ONLY

The following are trademarks and registered trademarks of Permobil Seating and Positioning: ACTA-BACK®, BodiLink®, COMFORT-TEK®, Compass®, and STRETCH-AIR®. GlideWear™ is a trademark of MIPS.