

# Etac Clean

## Manual

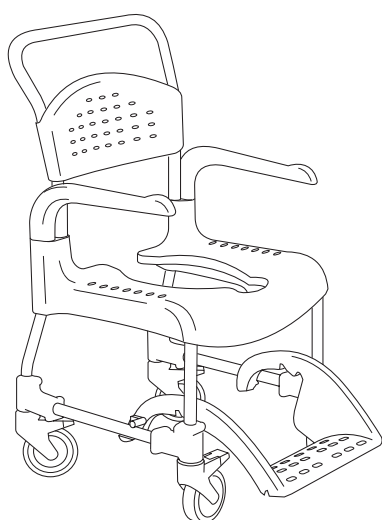

78548A 2013-09-09



Clean

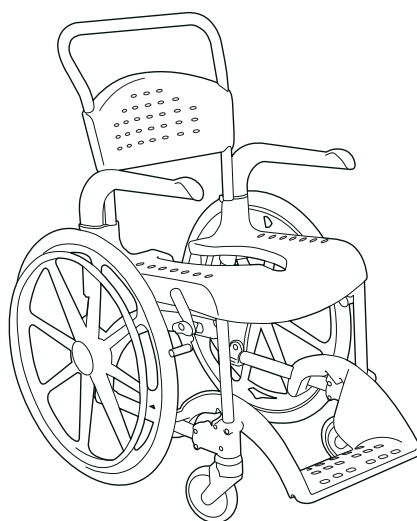

Clean 24"

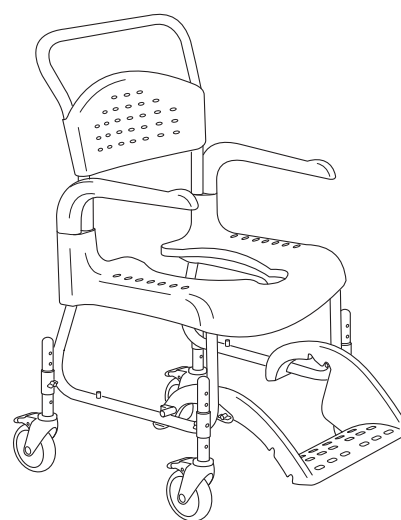

Clean HRB

EN

Contents

Images.....4-7

General ..... 14

Product description  
& dimensions table..... 14

Warranty / maintenance ..... 14

Safety..... 14

Transfers..... 14

Armrest..... 14

Height adjustment..... 15

Footrest..... 15

Backrest upholstery ..... 15

User brake ..... 15

Accessories..... 15

# A

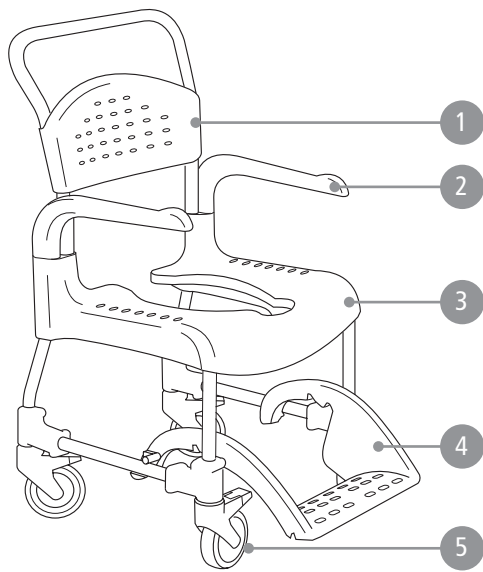

Clean

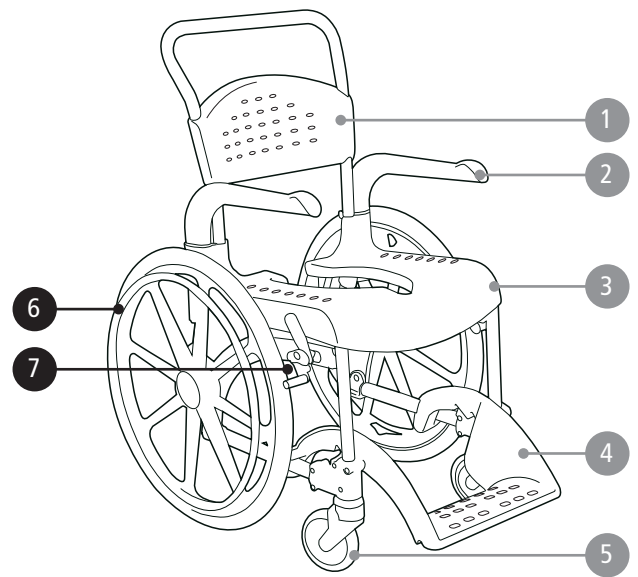



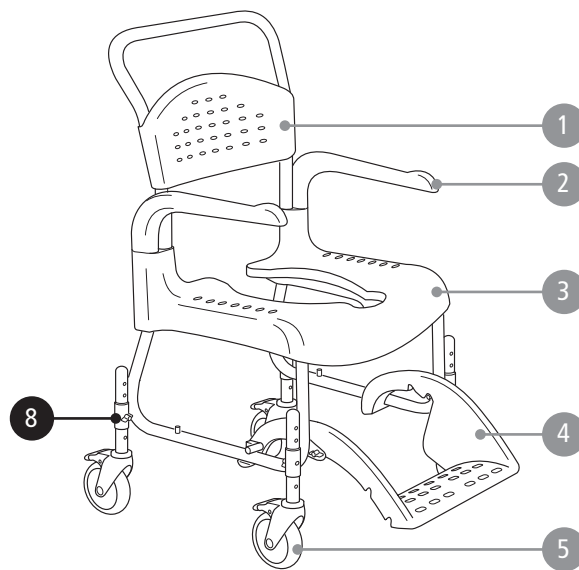









Clean 24"



Clean HRB

## A

						
Clean 44	52 cm	56,5 cm	98 cm	38,5* cm	44 cm	22 cm
Clean 49	52 cm	56,5 cm	103 cm	43,5* cm	49 cm	22 cm
Clean 55	52 cm	56,5 cm	107 cm	49,5* cm	55 cm	22 cm
Clean 60	52 cm	56,5 cm	112 cm	54,5* cm	60 cm	22 cm
Clean 24"	69 cm	56,5 cm	107 cm	49,5* cm	55 cm	22 cm
Clean HRB	54 cm	74 cm	102-114,5 cm	38-50,5* cm	47,5-60 cm	22 cm

						
Clean 44	7,5 cm	36 cm	48 cm	43,5 cm	13,5 kg	130 kg
Clean 49	12,5 cm	36 cm	48 cm	43,5 cm	14,0 kg	130 kg
Clean 55	12,5 cm	36 cm	48 cm	43,5 cm	14,5 kg	130 kg
Clean 60	12,5 cm	36 cm	48 cm	43,5 cm	15,0 kg	130 kg
Clean 24"	12,5 cm	36 cm	48 cm	43,5 cm	20,0 kg	130 kg
Clean HRB	12,5 cm	36 cm	48 cm	43,5 cm	14,2 kg	130 kg

EN\*With pan holders -1.5 cm

## B

1



2



3



4



5



6



## C

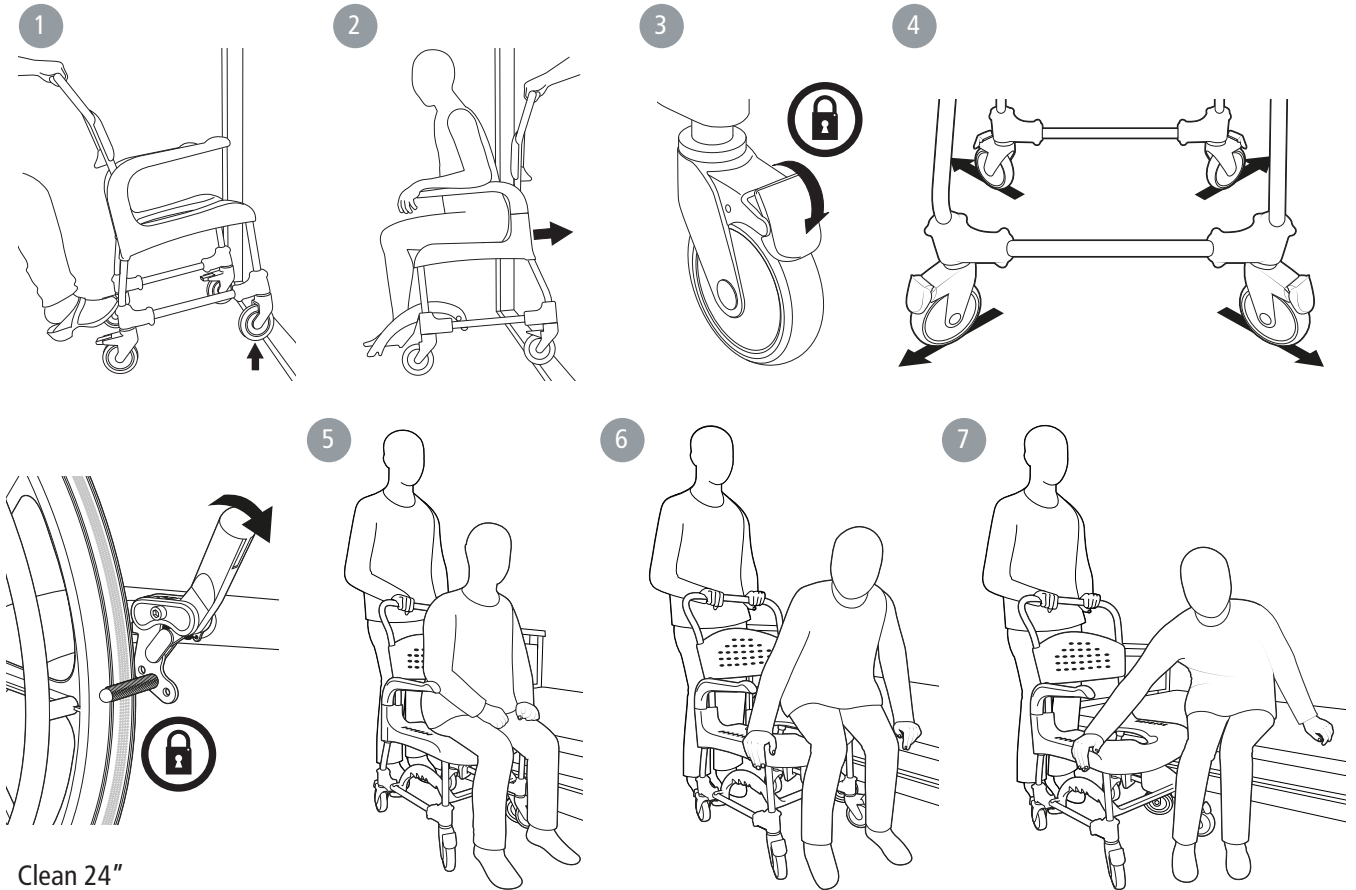

## D

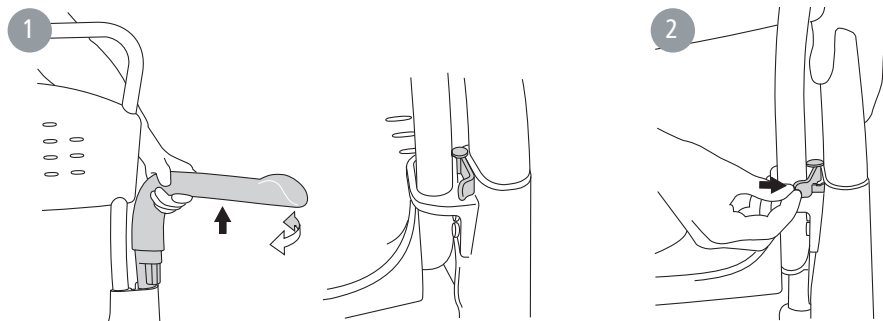

## E

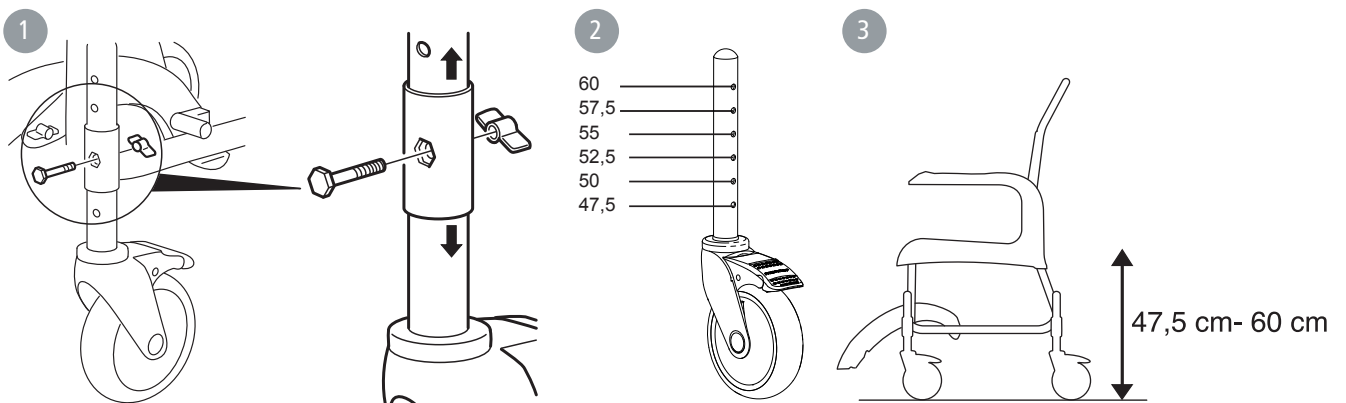

## F

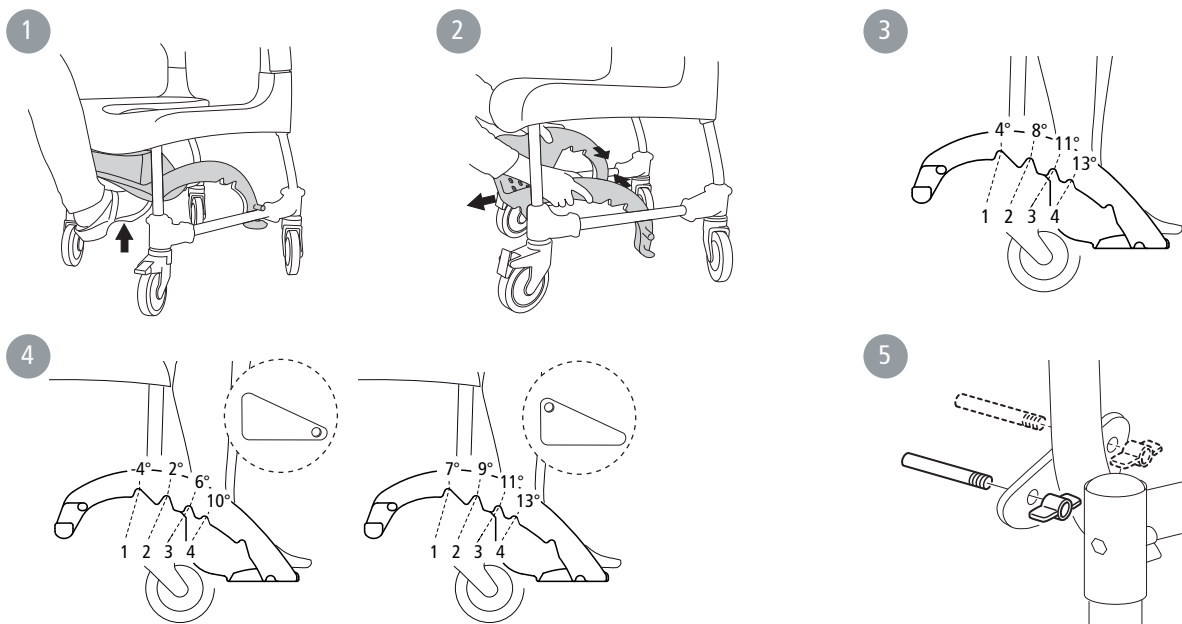

## G

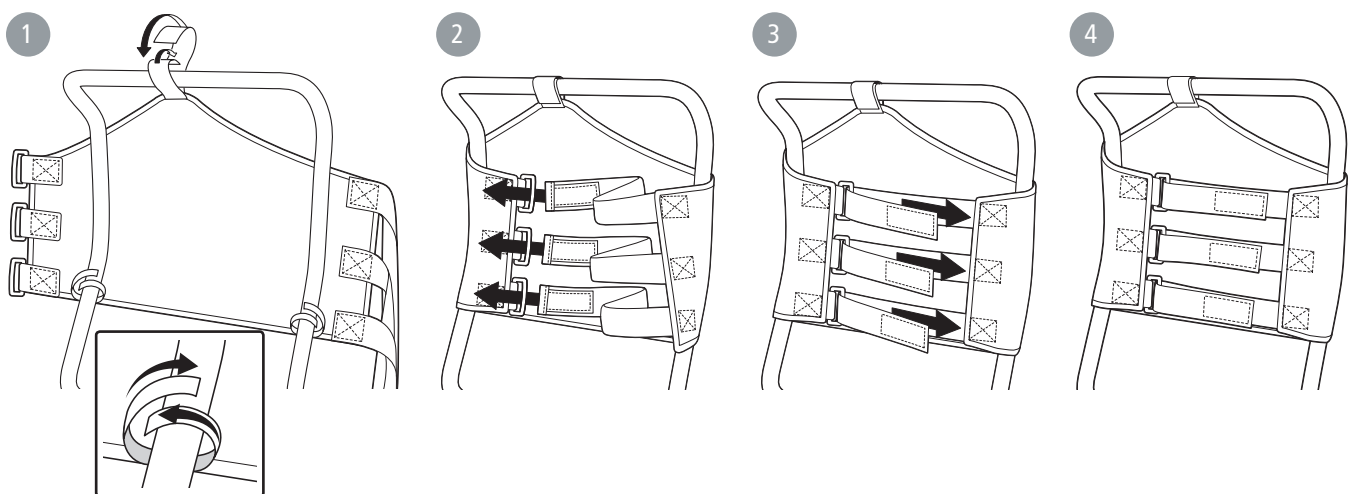

## H

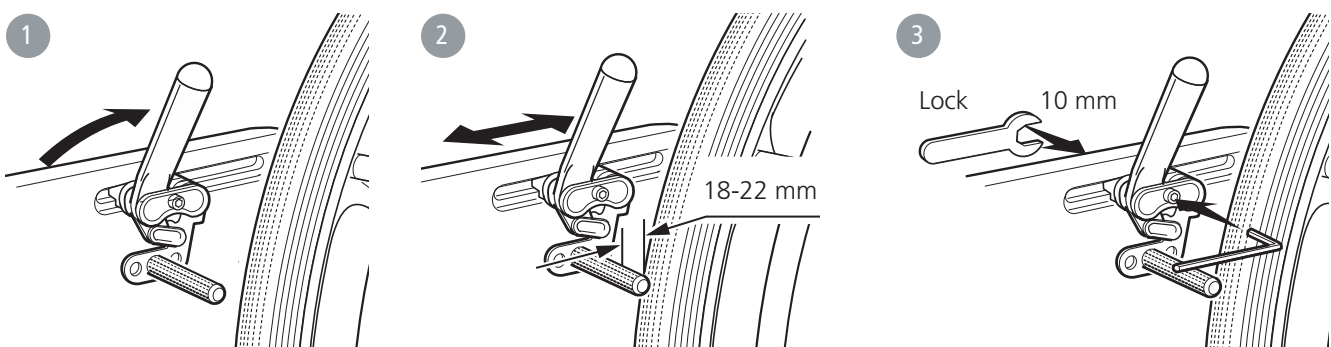

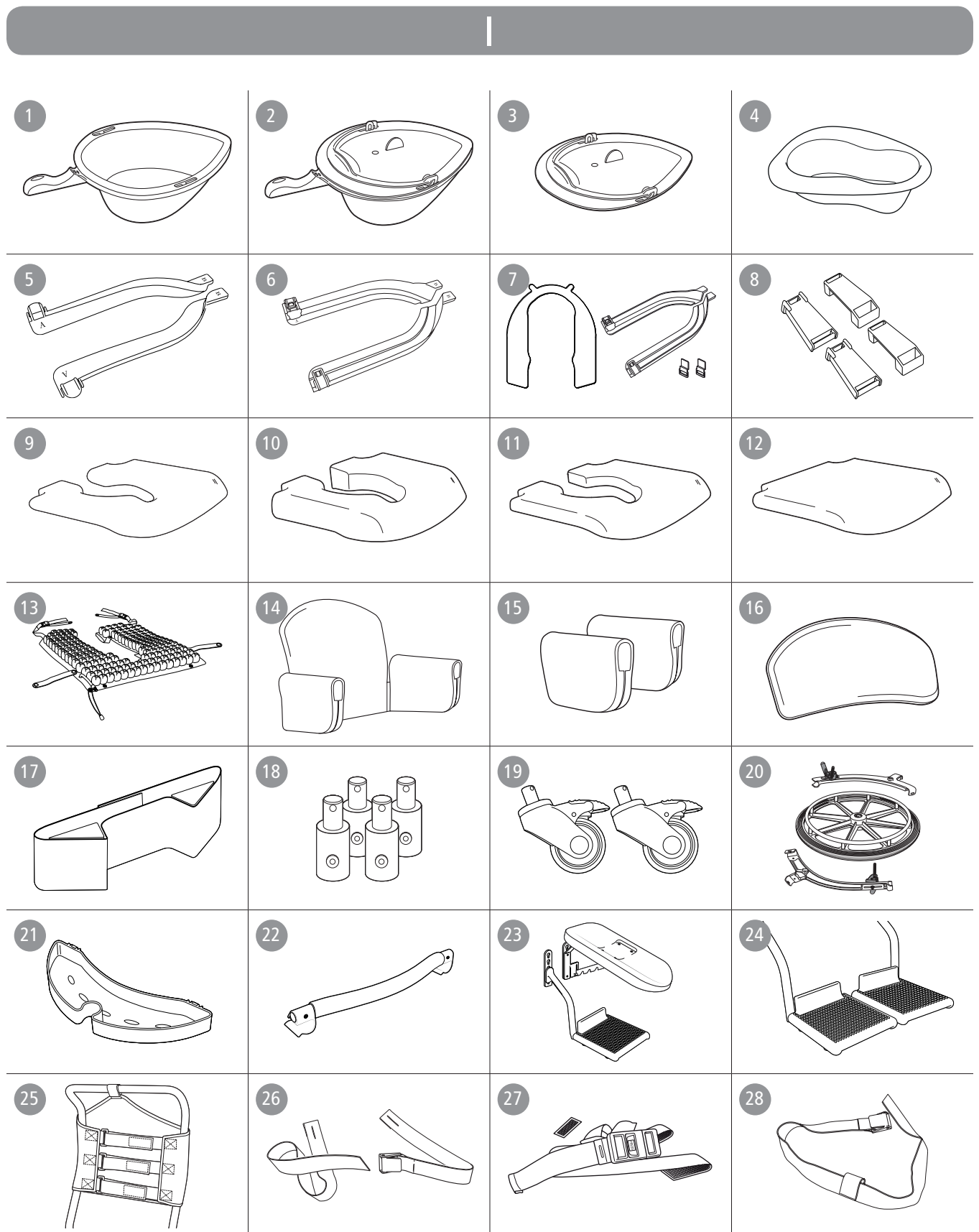

## English

Clean  
Clean 24"  
Clean HRB

## General

Thank you for choosing a shower chair from Etac.

In order to avoid injury during handling and use, please read through this manual first.

In the manual, the user is the person sitting in the chair. The assistant is the person operating the chair.

Clean is a mobile shower and toilet chair intended to make hygiene care easier for people with reduced mobility and their carers. It is designed for use in showers, with hand basins and over toilets, as well as for transport to and from the sanitary room. Every component of the chair is designed to make things easier for users and carers.

Clean can be used by people weighing a maximum of 130 kg.

Clean has been tested by a testing institute and complies with the requirements stated in EN ISO 10993-1 and SS EN 12182.



This product should be recycled as per national regulations.



This symbol appears in the manual along with text. It indicates instances where the safety of the user or the assistant may be at risk.



The images which are referred to on each page are found at the start of the manual (pages 3 to 7). See Figures A to J for the corresponding text.

Item list: ● = Applies to, ○ = Accessories

See the item list on the right which displays the information applicable to each product.

This manual covers the following products:

Clean	●
Clean 24"	●
Clean HRB (Height adjustable)	●

## Product description &amp; dimensions table

See Figure A

**A1.** Backrest, **A2.** Armrest, **A3.** Seat, **A4.** Foot support, **A5.** Castor wheel

**A6.** Rear wheel, **A7.** User brake

**A8.** Height adjustment

## Warranty / maintenance

See Figure B

5-year guarantee against material and manufacturing defects. For terms and conditions, see [www.etac.com](http://www.etac.com)

**Product lifetime:**

10 years (excluding soft pad/back) provided that Clean hrb is cleaned and maintained.

**Maintenance:**

To keep the chair in good and safe working order, you should regularly:

- Clean the chair with ordinary non-abrasive detergent. Rinse and dry.

- Keep the castors free of hair and soap deposits, etc.
- If your shower and toilet chair is not in perfect working order, contact your dealer.

**Symbols**

**B1.** Clean the chair with ordinary non-abrasive detergent. Rinse and dry.

**B2.** The product can be cleaned at 85 ° for 3 minutes.



## Safety

See Figure B



- Defective chairs must not be used.

**Symbols**

**B3.** Do not stand on the footrest, risk of tipping!

**B4.** Risk of pinching at armrest.

**B5.** Maximum user weight: 130 kg.

**B6.** Seating position affects the stability.

## Transfers

See Figure C

**Over a threshold:**

**C1.** Chair only, push down on the wheel attachment.

**C2.** With occupant, pull the chair backwards.

**In stationary position:**

**C3.** Always lock as many castors as possible when the chair is to be used in a stationary position.

**C4.** Out-turned castors improve the chair's stability.

**Transferring:**

Assess the risks and take notes. You as a carer are responsible for the safety of the user. Aids should be used if the transfer is deemed as risky. Visit [www.etac.com](http://www.etac.com) for manual transfer aids.

**C3-C4.** It is important to ensure that the castors are locked and pointing outward before carrying out transfers to and from Clean.

- Remove the armrest on the transfer side of the chair.

**C5-C7.** Carry out the transfer.

## Armrest

See Figure D

**D1.** The armrests are swing away and detachable.

**D2.** The armrests are lockable.



## English

## Height adjustment

See Figure E

**E1-3.** The height can be adjusted with ease by placing the screw in the required position.



Check that all four castors are similarly adjusted, otherwise stability will be reduced.



Do not use the chair if the wing nuts are loose.

## Footrest

See Figure F

**F1.** The carer can easily push in the footrest with their foot.

**F2.** The footrest is detachable.

**F3.** The footrest has 4 different angle and height settings.

**F4.** The footrest has 8 different angle and height settings.

**F5.** More adjustment options are available by moving the pin.



Remove the pins once the footrest has been removed.



When the chair is adjusted to a height of 47.5 cm, the lowest footrest position must not be used.

## Backrest upholstery

See Figure G

## User brake

See Figure H

## Accessories

See Figure I

The accessories section shows all the options that are available for your shower chair. Variations from standard can occur in different markets. Limitations in combinations of accessories may occur. For more information visit [www.etac.com](http://www.etac.com).

See Figure I		Clean	Clean 24"	Clean HRB	See Figure I		Clean	Clean 24"	Clean HRB
<b>I1.</b>	Pan	<input type="radio"/>	<input type="radio"/>	<input type="radio"/>	<b>I15.</b>	Armrest cushion, pair	<input type="radio"/>	<input type="radio"/>	<input type="radio"/>
<b>I2.</b>	Pan and lid with handle	<input type="radio"/>	<input type="radio"/>	<input type="radio"/>	<b>I16.</b>	Soft back	<input type="radio"/>	<input type="radio"/>	<input type="radio"/>
<b>I3.</b>	Lid with handle	<input type="radio"/>	<input type="radio"/>	<input type="radio"/>	<b>I17.</b>	Trunk support	<input type="radio"/>	<input type="radio"/>	<input type="radio"/>
<b>I4.</b>	Disposable pan	<input type="radio"/>	<input type="radio"/>	<input type="radio"/>	<b>I18.</b>	Heightening spacers	<input type="radio"/>	<input type="radio"/>	<input type="radio"/>
<b>I5.</b>	Pan holder	<input type="radio"/>	<input type="radio"/>	<input type="radio"/>	<b>I19.</b>	Two 80 mm lockable castors	<input type="radio"/>	<input type="radio"/>	<input type="radio"/>
<b>I6.</b>	Bucket holder	<input type="radio"/>	<input type="radio"/>	<input type="radio"/>	<b>I20.</b>	Rear wheel adaptor	<input type="radio"/>	<input checked="" type="radio"/>	<input type="radio"/>
<b>I7.</b>	Disposable pan holder	<input type="radio"/>	<input type="radio"/>	<input type="radio"/>	<b>I21.</b>	Soap dish	<input type="radio"/>	<input type="radio"/>	<input type="radio"/>
<b>I8.</b>	Attachment for low mounting of pan/bucket	<input type="radio"/>	<input type="radio"/>	<input type="radio"/>	<b>I22.</b>	Crossbar	<input type="radio"/>	<input type="radio"/>	<input type="radio"/>
<b>I9.</b>	Soft seat	<input type="radio"/>	<input type="radio"/>	<input type="radio"/>	<b>I23.</b>	Legrest, angle adjustable	<input type="radio"/>	<input type="radio"/>	<input type="radio"/>
<b>I10.</b>	Comfort seat	<input type="radio"/>	<input type="radio"/>	<input type="radio"/>	<b>I24.</b>	Foot support, foldable and detachable	<input type="radio"/>	<input type="radio"/>	<input type="radio"/>
<b>I11.</b>	Comfort cushion	<input type="radio"/>	<input type="radio"/>	<input type="radio"/>	<b>I25.</b>	Backrest upholstery	<input type="radio"/>	<input type="radio"/>	<input type="radio"/>
<b>I12.</b>	One-piece cushion	<input type="radio"/>	<input type="radio"/>	<input type="radio"/>	<b>I26.</b>	Safety belt	<input type="radio"/>	<input type="radio"/>	<input type="radio"/>
<b>I13.</b>	ROHO protect cushion, pressure-relieving	<input type="radio"/>	<input type="radio"/>	<input type="radio"/>	<b>I27.</b>	Positioning belt	<input type="radio"/>	<input type="radio"/>	<input type="radio"/>
<b>I14.</b>	Comfort padding	<input type="radio"/>	<input type="radio"/>	<input type="radio"/>	<b>I28.</b>	Chest harness belt	<input type="radio"/>	<input type="radio"/>	<input type="radio"/>