



# ROHO® Hybrid Elite® Cushion

## Operation Manual



Supplier: This manual must be given to the user of this product.

Operator (Individual or Caregiver): Before using this product, read the instructions and save for future reference.

## Table of Contents

Intended Use	2
Warnings and Cautions	2-3
Parts Detail	3
Product Specifications	3-4
Cushion Adjustment	5
Cover Removal and Replacement	6
Cushion Insert Removal and Replacement	6
Cleaning and Disinfecting	7-8
Troubleshooting, Disposal and Limited Warranty	8
Español	9
Français	17
Deutsch	25
Italiano	33
Nederlands	41
Dansk	49
Svenska	57
Norsk	65
Suomi	73
Português	81

## Intended Use

The ROHO® Hybrid Elite® Cushion (Hybrid Elite Cushion) is an adjustable, air-filled, wheelchair support surface combining a ROHO DRY FLOATATION® cellular design cushion insert with a contoured foam base and is intended to conform to an individual's seated shape in the pelvic loading area to provide skin/soft tissue protection, positioning, and an environment to facilitate wound healing. There is a weight limit of 500 lbs. (225 kg), and the cushion must be properly sized to the individual. The Hybrid Elite Cushion must be used with the supplied cover. Cushion models include:

- ROHO® Hybrid Elite® Single Compartment Cushion (Hybrid Elite Single Compartment Cushion)
- ROHO® Hybrid Elite® Dual Compartment Cushion (Hybrid Elite Dual Compartment Cushion)

ROHO, Inc. recommends evaluation by a clinician who is experienced in seating, positioning and mobility: 1) to determine whether the cushion is appropriate for the individual; and 2) to determine whether a solid seat platform is recommended if using the cushion on a sling-seat wheelchair.

*ROHO medical products are intended to be part of an overall care regimen. ROHO, Inc. recommends that a clinician make product recommendations based upon an evaluation of the individual's medical and therapeutic needs and overall condition.*

## Warnings

- **Skin/soft tissue breakdown can occur due to a number of factors, which vary by individual. Check skin frequently, at least once a day. Redness, bruising, or darker areas (when compared to normal skin) may indicate the beginning of soft tissue breakdown and may need to be addressed. If there is any discoloration to skin/soft tissue, STOP USE immediately. If the discoloration does not disappear within 30 minutes after disuse, immediately consult a healthcare professional.**
- **The cushion and the cover MUST be compatible sizes and MUST be used as directed in this manual. IF THEY ARE NOT: 1) The benefits provided by the cushion may be reduced or eliminated, increasing the risk to skin or to other soft tissue, and 2) the individual may become unstable and vulnerable to falling.**
- **DO NOT use your cushion on top of, or in conjunction with, any other products or materials, except as indicated in this manual. Doing so may cause the individual to become unstable and vulnerable to falling.**
- **DO NOT use the components of this product separately.**
- **DO NOT use this cushion as a water flotation device (e.g. a Life Preserver). It will NOT support you in water.**
- **If you are unable to perform any tasks described in this manual, seek assistance.**

## Cautions

- **DO NOT use a pump, cover, or a repair kit other than those provided by ROHO, Inc. Doing so may void your product's warranty.**
- **DO NOT modify the cushion or any components. Doing so may result in damage to the product and will void the warranty.**
- **DO NOT allow your cushion to come into contact with oil-based lotions or lanolin. They may degrade the material.**

## Cautions, Continued

- Prolonged exposure to ozone may degrade materials used in the cushion, affect the performance of the cushion, and void the product warranty.
- Changes in altitude may require adjustment to your cushion.
- Keep the cushion away from sharp objects.
- DO NOT expose the product to high heat, open flames, or hot ashes.
- If the cushion has been in temperatures lower than 32° F (0° C) and exhibits unusual stiffness, allow the cushion to warm to room temperature.
- DO NOT use the inflation valve as a handle for carrying or pulling the cushion. Carry the cushion by the cushion base or by the carrying handle on the cover.

## Parts Detail

### Package Contents:

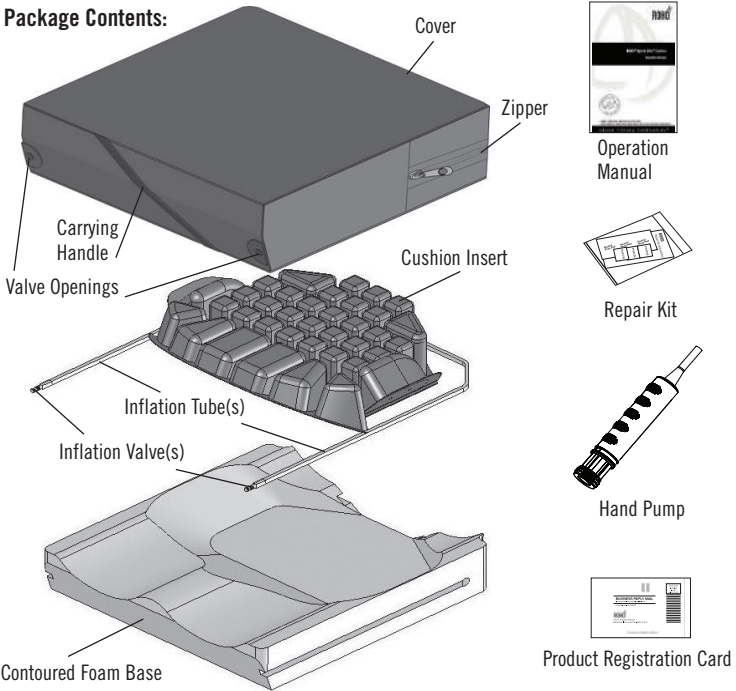

## Product Specifications

Materials: Cushion Insert: neoprene rubber; made without latex; Inflation Valve: nickel-plated brass; Contoured Foam Base: polyethylene closed cell foam; Standard Cover: two-way stretch, spacer fabric sides, with a zipper located in the back of the cover; and a non-skid bottom with hook and loop fasteners to help secure the cushion in the chair; Heavy Duty Cover: two-way stretch, fluid-resistant top and sides, with a zipper located in the front of the cover; and a non-skid bottom with hook and loop fasteners to help secure the cushion in the chair. Refer to cover care label for material content.

## Sizing Table

Cushion		Foam Base			
Single Valve	Dual Valve	Width (in.)	Depth* (in.)	Width (cm)	Depth* (cm)
1RHY1414C	2RHY1414C	13¾	14¾	35.0	37.5
1RHY1415C	2RHY1415C	13¾	15¾	35.0	40.0
1RHY1416C	2RHY1416C	13¾	16¾	35.0	43.0
1RHY1515C	2RHY1515C	14¾	15¾	37.5	40.0
1RHY1516C	2RHY1516C	14¾	16¾	37.5	43.0
1RHY1517C	2RHY1517C	14¾	17¾	37.5	45.0
1RHY1615C	2RHY1615C	15¾	15¾	40.0	40.0
1RHY1616C	2RHY1616C	15¾	16¾	40.0	43.0
1RHY1617C	2RHY1617C	15¾	17¾	40.0	45.0
1RHY1618C	2RHY1618C	15¾	18¾	40.0	48.0
1RHY1620C	2RHY1620C	15¾	20¾	40.0	53.0
1RHY1716C	2RHY1716C	16¾	16¾	43.0	43.0
1RHY1717C	2RHY1717C	16¾	17¾	43.0	45.0
1RHY1718C	2RHY1718C	16¾	18¾	43.0	48.0
1RHY1816C	2RHY1816C	17¾	16¾	45.0	43.0
1RHY1817C	2RHY1817C	17¾	17¾	45.0	45.0
1RHY1818C	2RHY1818C	17¾	18¾	45.0	48.0
1RHY1820C	2RHY1820C	17¾	20¾	45.0	53.0
1RHY2017C	2RHY2017C	19¾	17¾	50.0	45.0
1RHY2018C	2RHY2018C	19¾	20¾	50.0	48.0
1RHY2020C	2RHY2020C	19¾	20¾	50.0	53.0
1RHY2218C	2RHY2218C	21¾	18¾	55.5	48.0
1RHY2220C	2RHY2220C	21¾	20¾	55.5	53.0
1RHY2418C	2RHY2418C	23¾	18¾	60.5	48.0
1RHY2420C	2RHY2420C	23¾	20¾	60.5	53.0
Weight: 3¼ lbs. / 1.4 kg (based on 1RHY1817C)					
Height: 4 in. / 10.0 cm					

\*Depths shown include ¾ in. (1.5 cm) of foam base that fits between wheelchair back posts.

**Note:** All measurements are approximate. Width and depth measurements are taken from the top of the foam base and are rounded to the nearest ¼ in. or .5 cm. Cushion item numbers and cover tags indicate the wheelchair size the cushion is designed to fit.

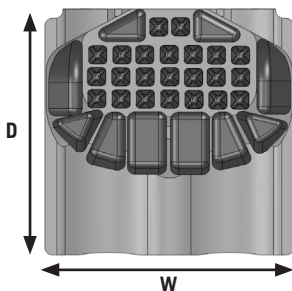

## Cushion Adjustment

### Important Safety Information

- Check inflation frequently, at least once a day!
- **DO NOT** use an under-inflated cushion or an over-inflated cushion because the product benefits will be reduced or eliminated, resulting in an increased risk to skin and other soft tissue. If the cushion does not appear to be holding air, or if you are not able to inflate or deflate the cushion, see TROUBLESHOOTING. Immediately contact your clinical caregiver, distributor, or ROHO, Inc. if the problem persists.
- When possible, use the hook or loop fasteners to further secure the cushion to the seating surface.
- The cover is not shown. The cushion must be used with the provided cover.

**Note:** For two-valve cushions, repeat all steps for both valves.

1. Place the cushion in the wheelchair with the air cells facing up and the non-skid surface of the cover facing down.

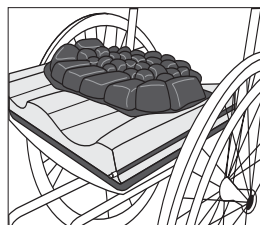

2. Slide the rubber nozzle of the hand pump over the inflation valve. Pinch the nozzle, open the inflation valve, and inflate the air cells.

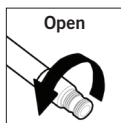

3. When the air cells begin to arch slightly, pinch the rubber nozzle of the hand pump and close the inflation valve completely. Remove the hand pump.

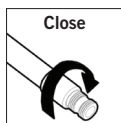

4. The individual should sit in the chair in their usual position. Confirm that the bony prominences are supported by the air cells.

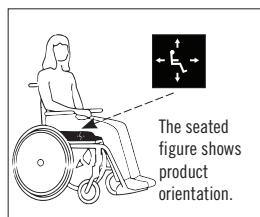

5. Slide your hand between the air cells and the individual. Lift the leg slightly and feel for the lowest bony prominence, and then lower the leg to a sitting position.

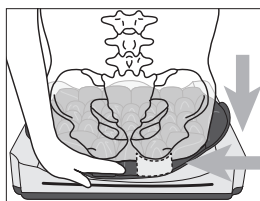

6. Open the valve to remove air, keeping your hand beneath the individual's lowest bony prominence. Release air until you are barely able to move your fingertips. Close the valve.

 = ½" - 1" (1.5 cm - 2.5 cm) recommended distance between the individual and the seating surface

## Cover Removal and Replacement



Inspect the cover for damage and replace if necessary.

### Cover Removal:

1. Unzip the cover.
2. Remove the cover from the cushion.

### Cover Replacement:

1. Unzip the cover.
2. Insert the cushion into the cover, front edge first. The air cells should face up and the non-skid surface of the cover should face down.
3. Reach inside the cover and push the inflation valve(s) through the valve opening(s) in the cover.
4. Zip the cover.
5. If the hook fastener strips were removed prior to washing, replace the strips.

## Cushion Insert Removal and Replacement



Inspect the foam portion of the product for damage and replace if necessary.

### Cushion Insert Removal:

1. Unzip the cover.
2. Slide the inflation tube out through the hole in the foam base corner. For a two-valve cushion, repeat for the other side.
3. Remove the air insert from the contoured foam base.

### Cushion Insert Replacement:

1. Line up the hook and loop fastener strips and refer to the directional labels to correctly place the air insert onto the foam base. Press to attach securely.
2. Insert the inflation tube through the hole in the foam base corner. For a two-valve cushion, repeat for the other side.
3. Press the inflation tube(s) into the groove(s) in the foam base. The inflation valve(s) should face the front of the cushion.

## Cleaning and Disinfecting



**Cleaning and disinfecting are separate processes. Cleaning must precede disinfection. Before use by a different individual: clean, disinfect, and check product for proper functioning.**

Cover Care: Before cleaning and disinfecting, remove the cover from the cushion. Remove the hook fastener pieces from bottom of the cover.

To Clean the Cover: Machine wash in cold water (30°C) with mild detergent, gentle cycle, or wipe clean with neutral detergent and cold water. Tumble dry low.



To Disinfect the Cover: Hand wash in cold water (30°C) using 1 part household liquid bleach per 9 parts water. Keep the product wet with the bleach solution for 10 minutes, and then rinse thoroughly. Or machine wash in hot water (60°C). Tumble dry low.



+



**Follow the safety guidelines on the bleach container.**



**Cushion Care Cautions:** Valve(s) must be closed. • DO NOT allow water or cleaning solution to enter the cushion overlay. • DO NOT machine wash or machine dry the cushion insert or the contoured foam base. • Use of the following may cause damage to the cushion: abrasives (steel wool, scouring pads); caustic, automatic dishwasher detergents; cleaning products that contain petroleum or organic solvents, including acetone, toluene, Methyl Ethyl Ketone (MEK), naphtha, dry cleaning fluid, adhesive remover; oil-based lotions, lanolin, or phenolic-based disinfectants; ozone gas; ultraviolet light cleaning methods.

To Clean the Cushion Insert: Carefully remove the cushion insert from the contoured foam base. Close the inflation valve(s). Hand wash, using mild liquid hand soap, hand dishwashing liquid, laundry detergent, or a multipurpose detergent (Follow product label instructions.) Gently scrub all cushion surfaces, using a soft plastic bristle brush, a sponge or a cloth. Rinse with clean water. Air dry. DO NOT expose to direct sunlight.

To Disinfect the Cushion Insert: Repeat cleaning instructions, using 1 part household liquid bleach per 9 parts water. Keep the product wet with the bleach solution for 10 minutes. Rinse thoroughly with clean water. Air dry.



**Follow the safety guidelines on the bleach container.**

To Clean the Contoured Foam Base: Remove the cover. Wipe gently with a cloth dampened with water and a household detergent. Rinse cloth and re-wipe. Allow foam to air dry thoroughly before putting the cover on.



This symbol means, "Wipe with a damp cloth."



**Disinfectants are not effective on porous surfaces such as foam. If the foam portion of the product becomes soiled or contaminated, DO NOT use with multiple individuals. Replace soiled or contaminated foam components.**

**Note:** Most germicidal disinfectants are safe if used following the disinfectant manufacturer's dilution directions.



## Cleaning and Disinfecting, Continued



**Note About Sterilization:** High temperatures accelerate aging and will damage the product assembly. ROHO products are not packaged in a sterile condition, nor are they intended or required to be sterilized prior to use. If institution protocol demands sterilization: First, follow the cleaning and disinfecting instructions; then, open the inflation valve and use the lowest possible sterilizing temperature, but not to exceed 60°C (158°F), for the shortest time possible. **DO NOT** autoclave.

### Troubleshooting

For additional assistance, contact your clinical caregiver, distributor, or ROHO, Inc.

**Not Holding Air** - Inspect for inflation valve and hose damage. Confirm that the inflation valve(s) are completely closed (turn clockwise). Look for holes in the cushion. If very small holes or no holes are visible, follow the instructions in the Repair Kit provided with your product. For inflation valve or hose damage, or for large holes or leaks in the cushion, see the ROHO Limited Warranty supplement, or contact Customer Care.

**Not Able To Inflate or Deflate Cushion** - Confirm that the inflation valve(s) are open. Inspect the inflation valve(s) and hose(s) for damage.

**Uncomfortable / Unstable** - Confirm that:

- the air cells are not over-inflated (See CUSHION ADJUSTMENT.)
- the air cells and the top of the cover are facing up.
- the cushion is centered beneath the individual.
- the cushion is properly sized to the individual and the wheelchair.

Allow the individual at least one hour to adjust to the cushion.

**The Cushion Slides on the Wheelchair** - Make sure the non-skid bottom of the cushion cover is facing down. Use directional labels on the cushion and on the cover to orient the cushion. Use hook and loop fasteners to further secure the cushion to the wheelchair.

## Disposal

The components of the products in this manual are associated with no known environmental hazards when properly used and when disposed of in accordance with all local/regional regulations. Incineration must be performed by a qualified, licensed waste management facility.

## Limited Warranty

Limited Warranty Term: 24 months from the date the product was originally purchased. The warranty does not apply to punctures, tears or burns, nor does it apply to the removable cover. See also the ROHO Limited Warranty supplement provided with your product, or contact Customer Care.